

CITY OF MARYSVILLE

CONSTRUCTION STANDARD DETAILS



PUBLIC WORKS DEPARTMENT

MARCH 2024

CITY OF MARYSVILLE STANDARD DETAILS

101	Curb & Gutter – Roll, 6” Barrier, & 8” Barrier
101 A	6” Curb & Dike
102	Cross Gutter & Curb Transition
103	Sidewalks Curb & Gutter
104	Standard Driveway
105	Heavy-Duty Driveway
106	Accessible Ramps – Refers to Caltrans Detail A88A
107	Monument Well
108	Barricades
109	Street Signs
110	Stop Bar Placement
111	Alternate Driveway
201	Sanitary Sewer Cleanout
202	Sanitary Sewer Service & Connection
203	Sanitary Sewer & Storm Drain Manhole
204	Sanitary Sewer Service Cleanout
205	Sanitary Sewer Special Manhole
301	Junction Box for Pipes 30” Diameter or Greater
302	Manhole for Pipe 30” Diameter or Greater
303	Catch Basin
304	Drop Inlet Drainage Grate Assembly
305	Drop Inlet
306	Junction Drop Inlet Detail
307	Manhole Frame & Cover
308	Under Sidewalk Drain
501	Bedding & Initial Backfill
502	Surface Restoration
503	Joint Trench Configurations for Utility Companies
504	Utility Crossing
601	Off Street Parking Layout
602	On Street Accessible Parking Stall
603	General Fence Requirements

LIGHTING DETAILS

701	Street Light Pole Foundation Detail
702	Street Light Pole and Mast Arm Detail
703	Street Light Base and Pull Box Detail
704	Street Light Luminaire Detail
705	Street Light Banners
706	Red Light Monitoring

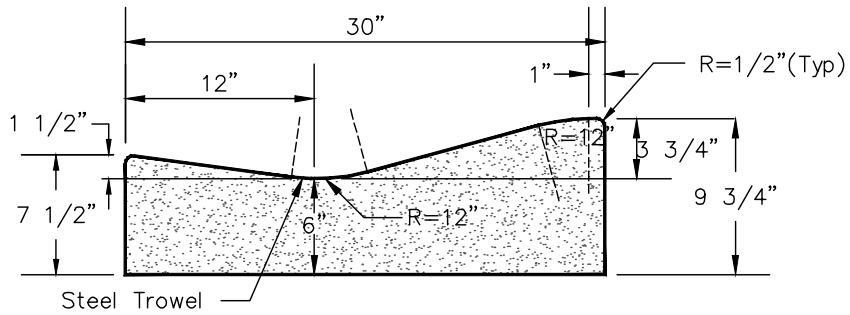

ROLL CURB (FOR REPLACEMENT ONLY)

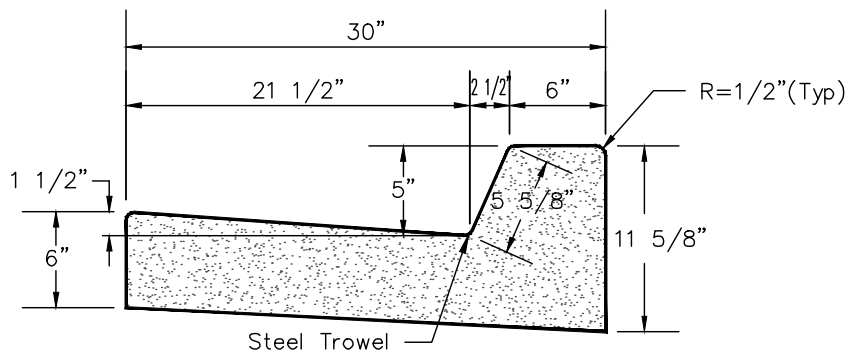

6" BARRIER CURB

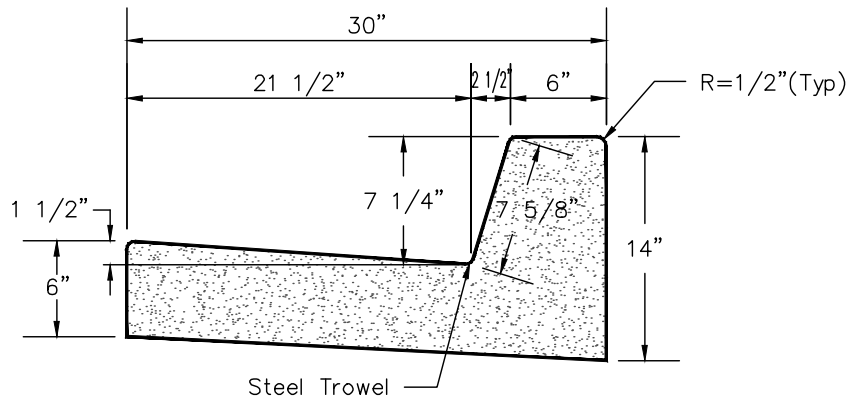

8" BARRIER CURB

NOTES:

1. ALL CONCRETE CURBS SHALL HAVE A MINIMUM OF 6 INCHES OF AGGREGATE BASE UNDERNEATH.



APPROVED _____ DATE _____

DATE	REVISIONS	BY

STANDARD DETAIL 101

CURB & GUTTER - ROLL, 6" BARRIER, & 8" BARRIER

CITY OF MARYSVILLE
PUBLIC WORKS DEPARTMENT

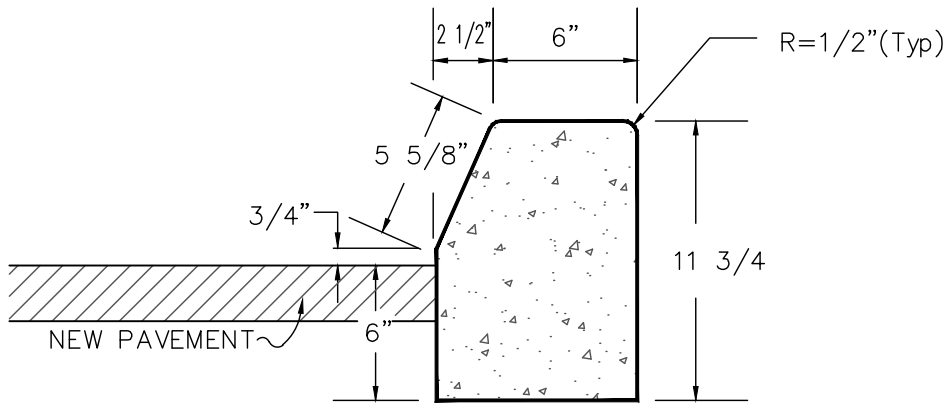

6" P.P.C. CURB (TYPE A)

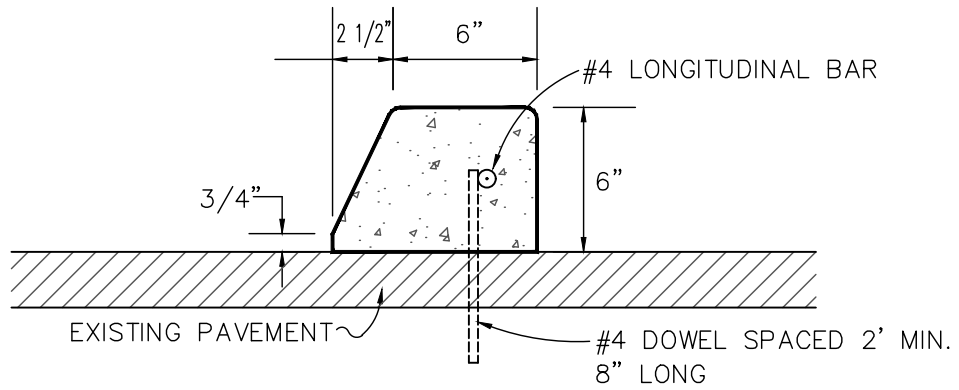

6" P.C.C. CURB (TYPE B)

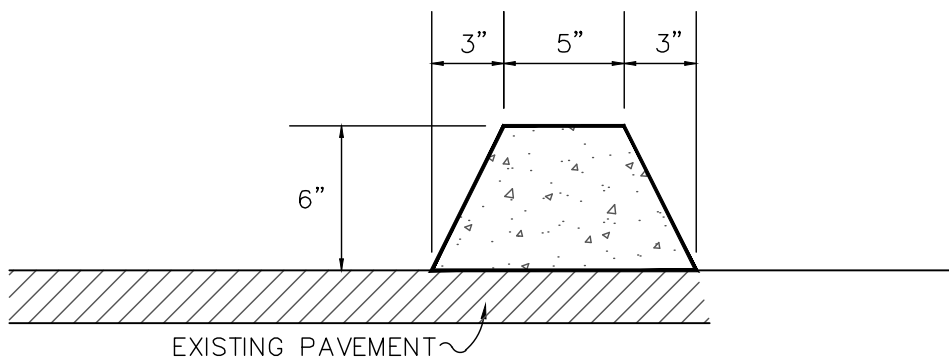

6" A.C. DIKE



APPROVED _____ DATE _____

DATE	REVISIONS	BY

STANDARD DETAIL 101A

6" CURB & DIKE
CITY OF MARYSVILLE
PUBLIC WORKS DEPARTMENT

NOTE:
 VERTICAL CURB & GUTTER TO BE USED AT
 ALL CURB RETURNS WITH 1/4" EXPANSION
 JOINT AT BOTH ENDS OF CURB RETURN AND
 EDGES OF WHEEL CHAIR RAMP.

BRONZE BENCH MARK -
 1 3/8" DIA. CROWNED TOP, WITH
 A 7/16" X 2" SHANK. (LOCATION
 AS SHOWN ON PLANS)

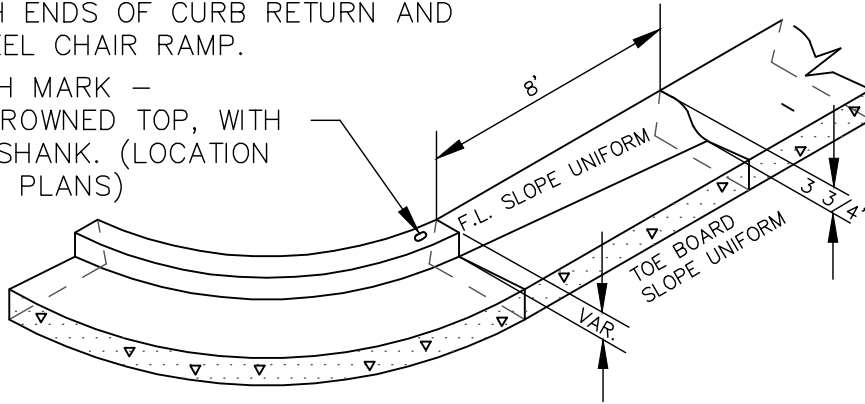

BARRIER C & G TO ROLL C & G TRANSITION

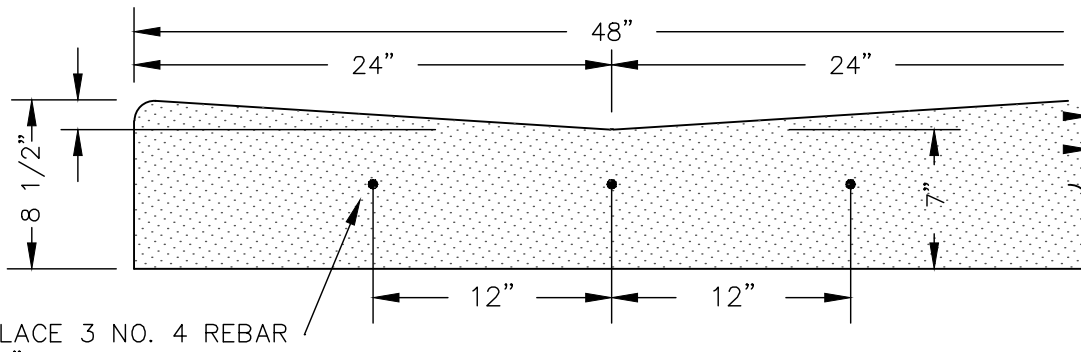
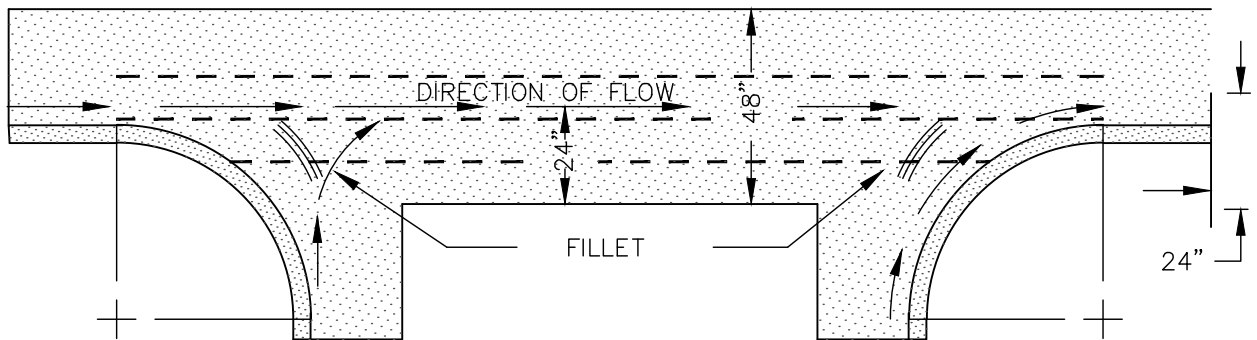

PLACE 3 NO. 4 REBAR
 12" O.C.

CROSS GUTTER



APPROVED _____ DATE _____

DATE	REVISIONS	BY

STANDARD DETAIL 102

**CROSS GUTTER & CURB TRANSITION
 CITY OF MARYSVILLE
 PUBLIC WORKS DEPARTMENT**

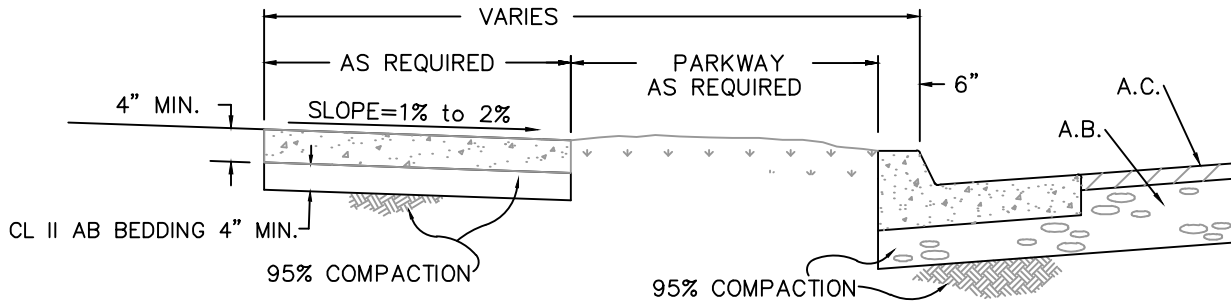
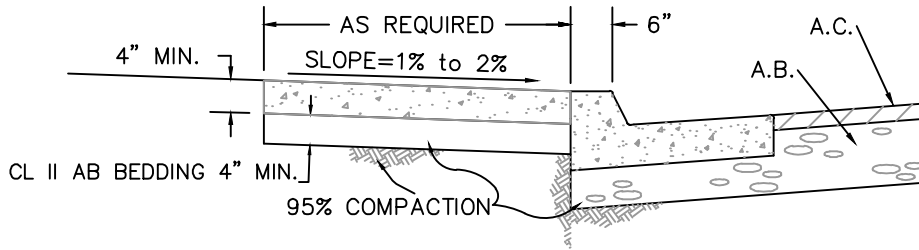

MIN. WIDTH OF SIDEWALK		
ARTERIAL	COLLECTOR	RESIDENTIAL
6'	5'	4'

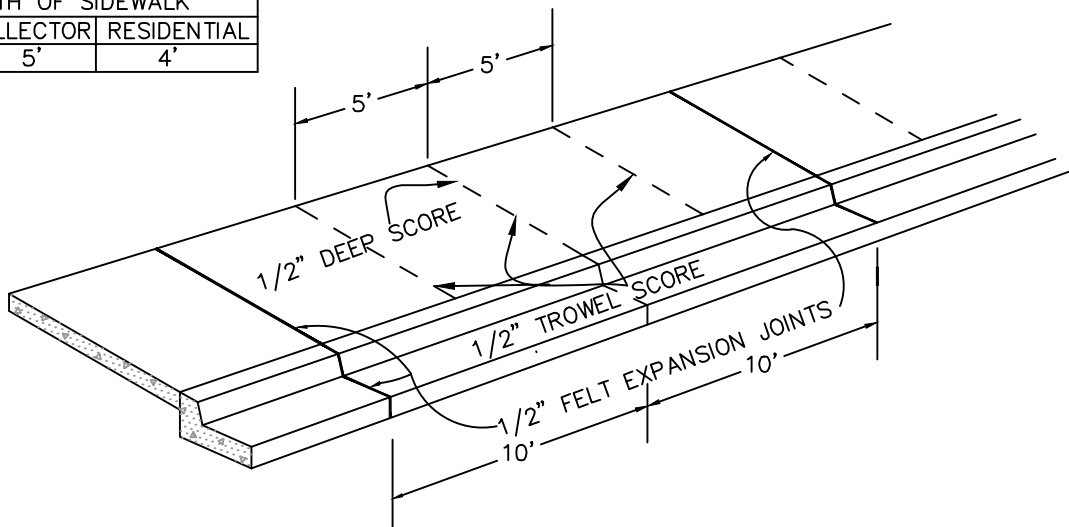

NOTES:

1. PROVIDE 1/2" DEEP SCORE AT 5' INTERVALS IN SIDEWALK.
2. 1/2" TRANSVERSE EXPANSION JOINTS AT 20' INTERVAL FOR SIDEWALK.
3. 1/2" TRANSVERSE EXPANSION JOINTS AT 20' INTERVAL FOR CURB & GUTTER.
4. CURB & GUTTER TO HAVE 1/2" DEEP SCORE @ 10' INTERVALS.
5. EXPANSION JOINTS IN SIDEWALK TO BE ADJACENT TO EXPANSION JOINTS IN CURB & GUTTER.
6. ALL EXPANSION JOINTS SHALL EXTEND COMPLETELY THROUGH CONCRETE VERTICALLY AND HORIZONTALLY.
7. CONCRETE TO MEET MIN 2500 PSI WITH MAX SLUMP OF 4" OR MEET CALTRANS REQUIREMENTS IN THE STANDARD SPECIFICATIONS SECTIONS 73 & 90.
8. SIDEWALK TO HAVE A TRANSVERSE BROOMED SURFACE TEXTURE.
9. SIDEWALK SHALL BE POURED SEPARATELY FROM CURB UNLESS OTHERWISE APPROVED BY THE CITY ENGINEER.
10. ALL CURB & GUTTER REPLACEMENTS REQUIRE THE REMOVAL & REPLACEMENT OF ADJACENT 3' STRIP OF AC.



APPROVED _____ DATE _____

DATE	REVISIONS	BY

STANDARD DETAIL 103

SIDEWALK
CITY OF MARYSVILLE
PUBLIC WORKS DEPARTMENT

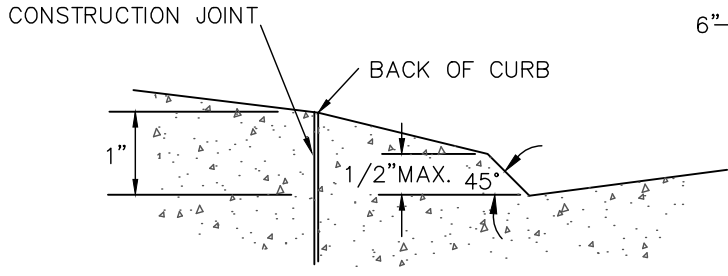
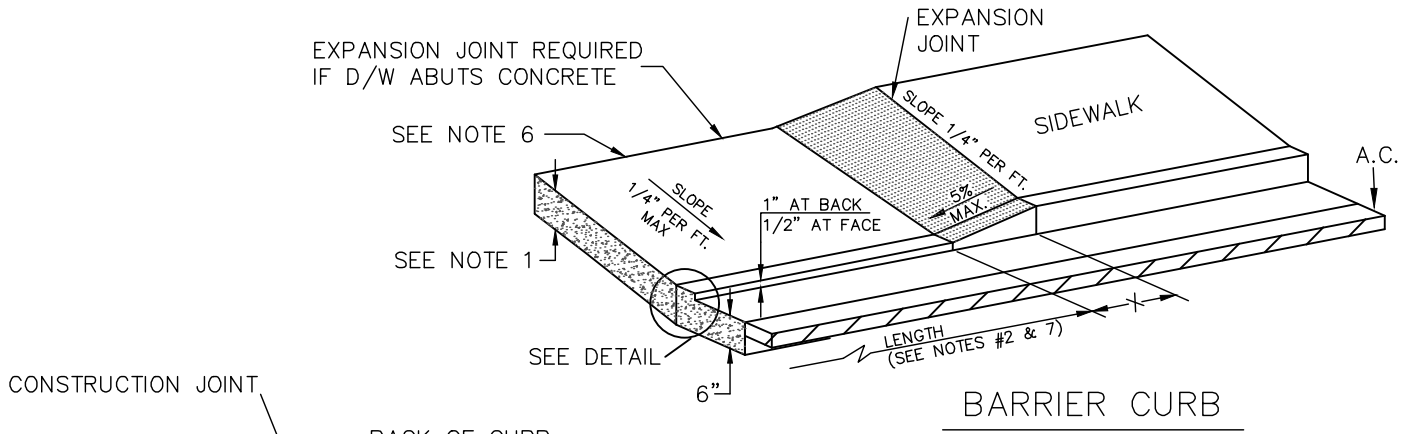

DETAIL

BARRIER CURB

"X" LENGTH		
ROLL	6" CURB	8" CURB
	4.5'	10.4'

NOTES:

1. MIN. D/W SLAB THICKNESS IN SINGLE FAMILY RESIDENTIAL AREAS SHALL BE 4".
2. MIN. LENGTH OF RESIDENTIAL D/W SHALL BE 12' & MAX. LENGTH 24'.
3. ALL CONCRETE REMOVALS SHALL BE TO NEAT SAW CUT LINES.
4. 90% RELATIVE COMPACTION REQUIRED ON SUBGRADE.
5. DRIVEWAY APPROACH SHALL BE POURED SEPARATELY WITH CURB UNLESS OTHERWISE APPROVED BY THE ENGINEER.
6. ON SITE GRADING MAY BE REQUIRED TO ELIMINATE EXCESSIVE GRADE CHANGE AND TO MAINTAIN SUITABLE DRAINAGE.
7. MAXIMUM CURB OPENING MAY BE INCREASED DUE TO SPECIAL CONDITIONS ON APPROVAL OF THE CITY ENGINEER.
8. ALL CURB & GUTTER REPLACEMENTS REQUIRE THE REMOVAL & REPLACEMENT OF ADJACENT 3' STRIP OF AC.

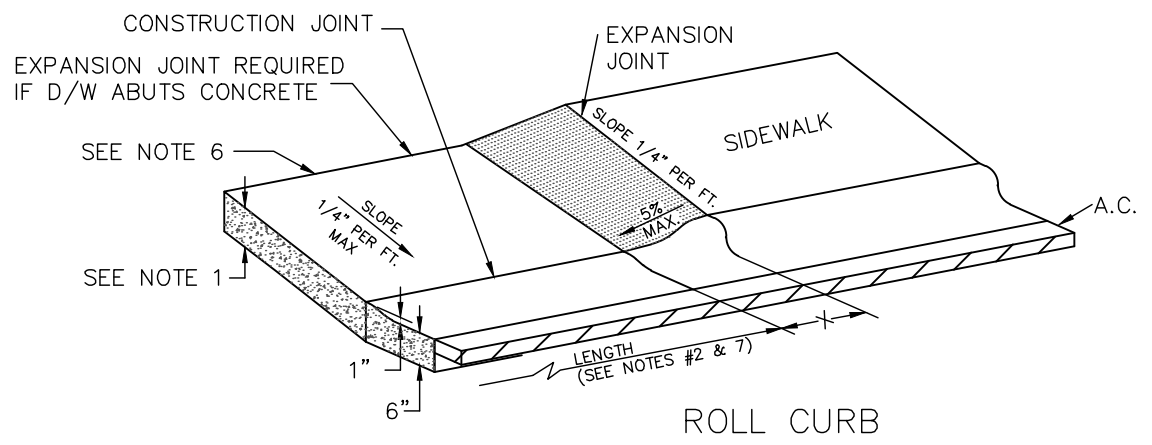

ROLL CURB



APPROVED		DATE	
DATE	REVISIONS		BY

STANDARD DETAIL 104
STANDARD DRIVEWAY
CITY OF MARYSVILLE
PUBLIC WORKS DEPARTMENT

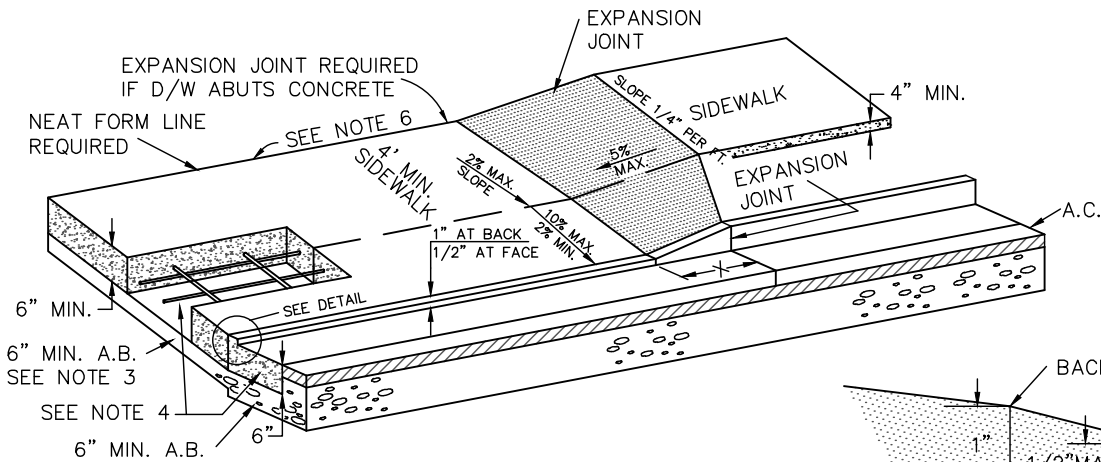

SIDEWALKS PARKWAYS 8' & GREATER

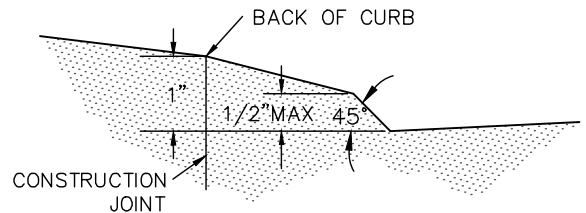

DETAIL

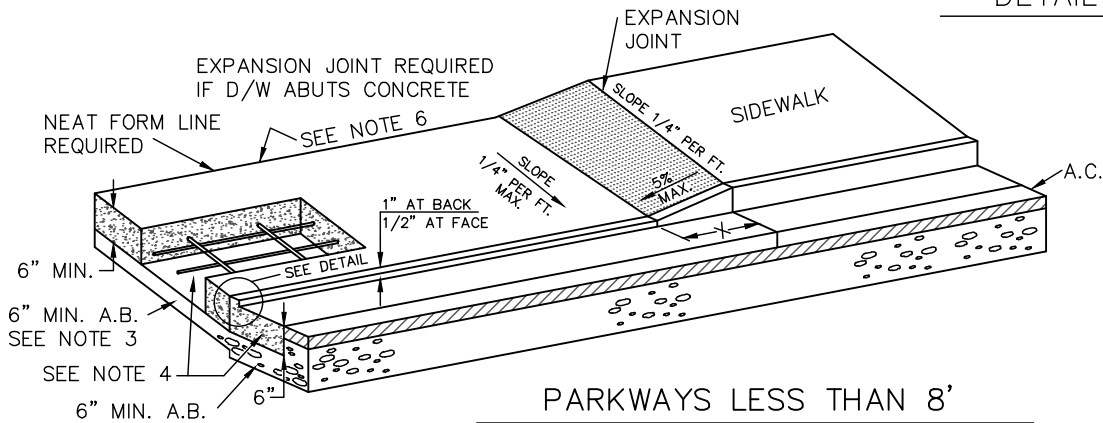

PARKWAYS LESS THAN 8'

NOTES:

1. ALL CONCRETE REMOVALS SHALL BE TO NEAT SAW CUT LINES.
2. 90% RELATIVE COMPACTION REQUIRED ON SUBGRADE.
3. 1" ADDITIONAL CONCRETE THICKNESS MAY BE SUBSTITUTED FOR 4" REQUIRED OF THE CLASS 2 A.B.
4. ALL DRIVEWAYS SHALL HAVE 2 NO. 4 REBARS 12" O.C. IN THE GUTTER AND NO. 4 REBARS 18" O.C. THROUGHOUT THE APPROACH.
5. D/W APPROACH SHALL BE POURED SEPARATELY WITH CURB UNLESS OTHERWISE APPROVED BY THE ENGR.
6. ON SITE GRADING MAY BE REQUIRED TO ELIMINATE EXCESSIVE GRADE CHANGE AND TO MAINTAIN SUITABLE DRAINAGE.
7. MAXIMUM CURB OPENING MAY BE INCREASED DUE TO SPECIAL CONDITIONS ON APPROVAL OF CITY ENGINEER.
8. ALL CURB & GUTTER REPLACEMENTS REQUIRE THE REMOVAL & REPLACEMENT OF ADJACENT 3' STRIP OF AC.

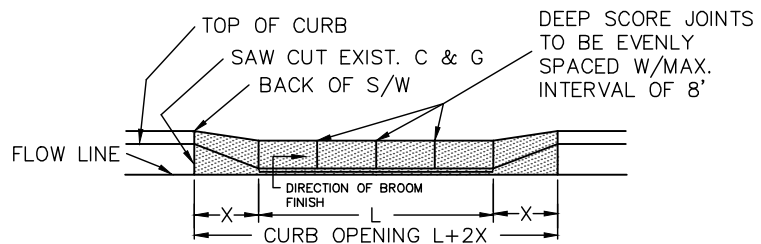

PARKWAY WIDTH	X LENGTH		MIN. L	MAX. L
	6" CURB	8" CURB		
≥ 8'	4'	6'	16'	36'
< 8'	6.7'	10.4'	12'	36'



APPROVED		DATE	
DATE	REVISIONS		BY

STANDARD DETAIL 105
COMMERCIAL DRIVEWAY
CITY OF MARYSVILLE
PUBLIC WORKS DEPARTMENT

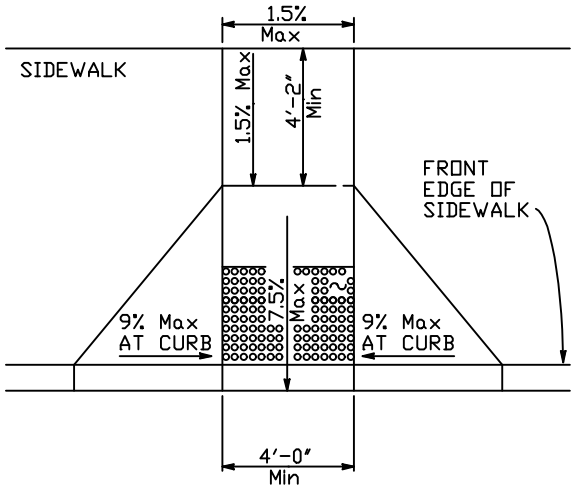

HANDICAP RAMP CASE A
FOR SIDEWALKS GREATER THAN 6'
OR WITH PARKWAYS'

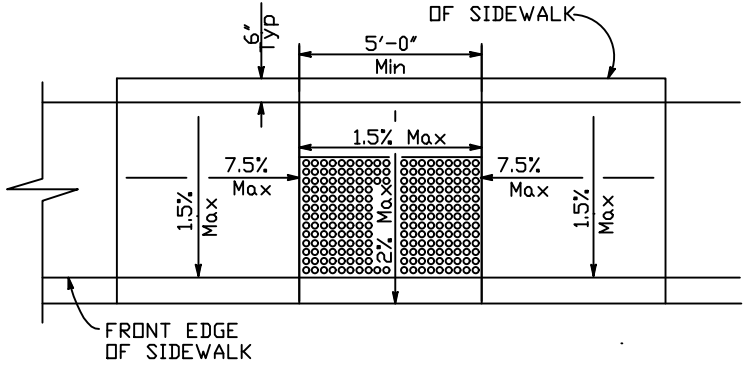

HANDICAP RAMP CASE C
FOR SIDEWALKS 6' AND LESS

NOTES:

1. SEE THE LATEST CALTRANS STANDARD PLAN A88A FOR ALL DETAILS ON THE RAMP CONSTRUCTION
2. ALL TRUNCATED DOMES ON RAMPS LOCATED IN WEST MARYSVILLE (WEST OF A STREET) SHALL BE BRICK COLOR OR CONSTRUCTED OF PAVERS.
3. RAMP SIDEWALK SHALL BE POURED SEPARATELY FROM CURB UNLESS OTHERWISE APPROVED BY THE CITY ENGINEER.
4. ALL CURB & GUTTER REPLACEMENT FOR RAMP INSTALLATION REQUIRE THE REMOVAL & REPLACEMENT OF ADJACENT 3' STRIP OF AC.



	APPROVED _____	DATE _____
DATE	REVISIONS	BY

STANDARD DETAIL 106

ACCESSIBLE RAMPS

CITY OF MARYSVILLE
PUBLIC WORKS DEPARTMENT

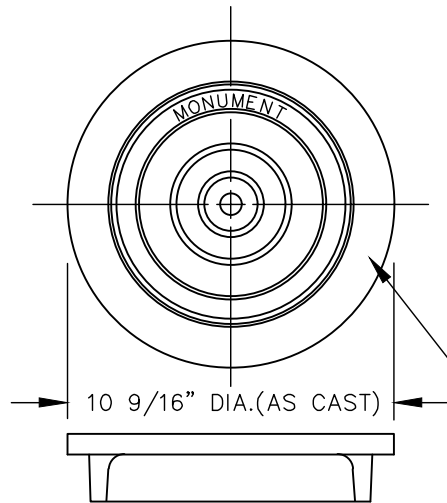

COVER DETAIL

D AND L SUPPLY 9 1/2"
TRAFFIC VALVE BOX TYPE
80-60-03 OR APPROVED
EQUAL MARKED "MONUMENT"
PART NO. K-6016

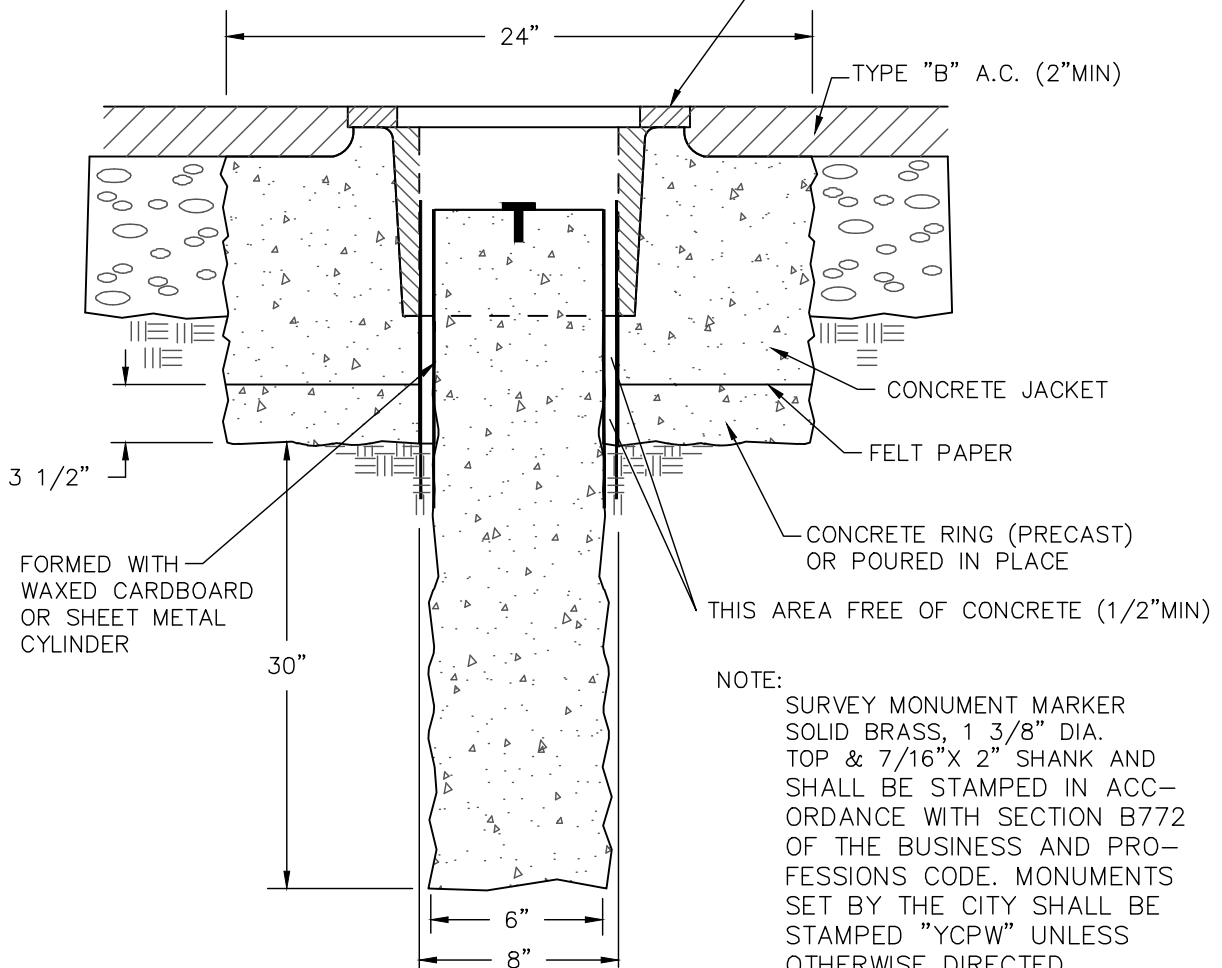

APPROVED _____ DATE _____

DATE	REVISIONS	BY

STANDARD DETAIL 107

MONUMENT WELL
CITY OF MARYSVILLE
PUBLIC WORKS DEPARTMENT

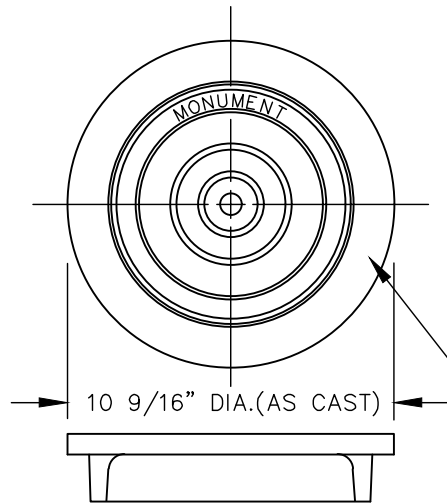

COVER DETAIL

D AND L SUPPLY 9 1/2"
TRAFFIC VALVE BOX TYPE
80-60-03 OR APPROVED
EQUAL MARKED "MONUMENT"
PART NO. K-6016

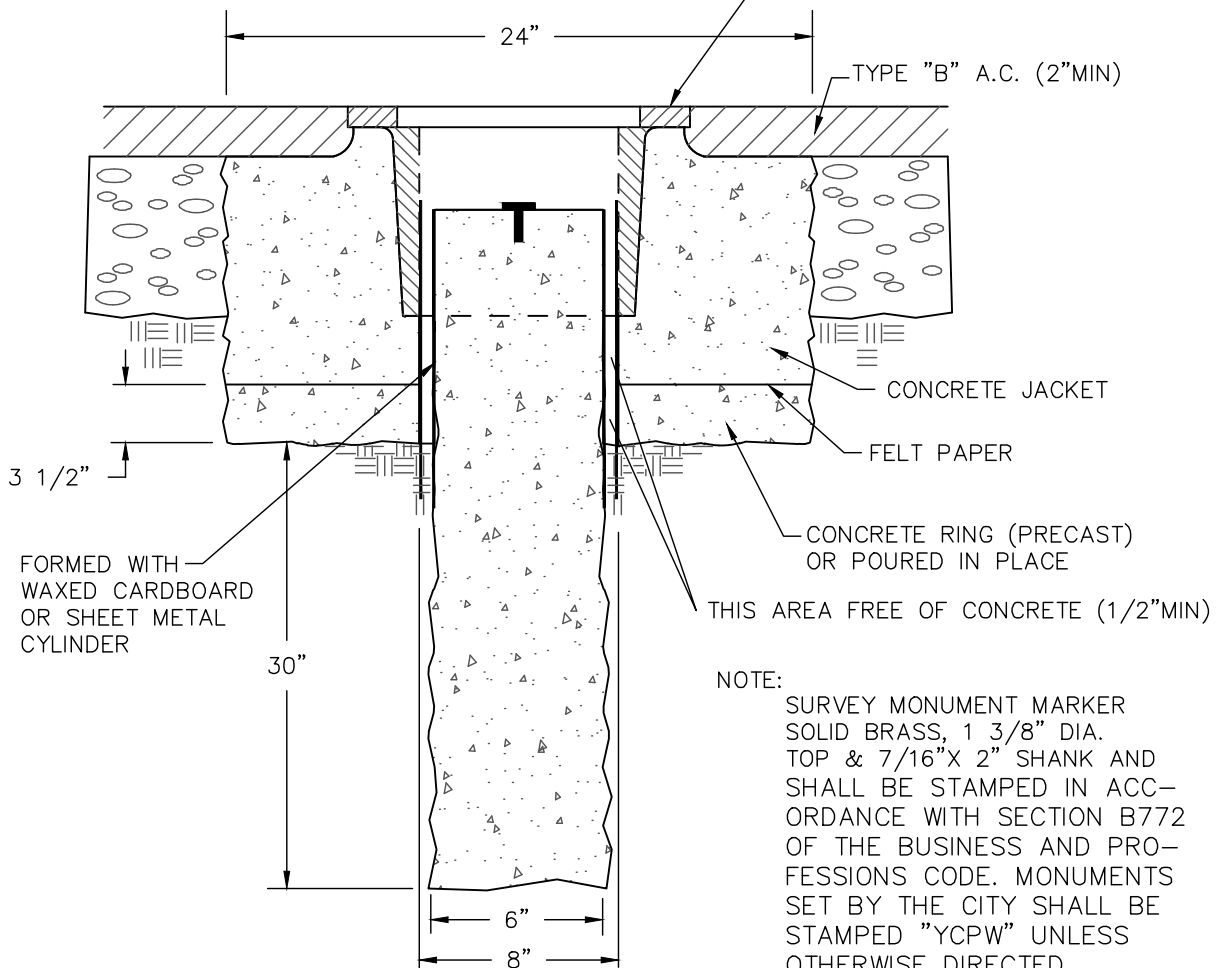

APPROVED _____ DATE _____

DATE	REVISIONS	BY

STANDARD DETAIL 107

MONUMENT WELL
CITY OF MARYSVILLE
PUBLIC WORKS DEPARTMENT

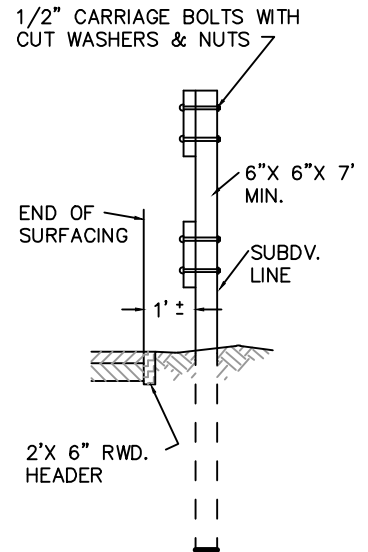
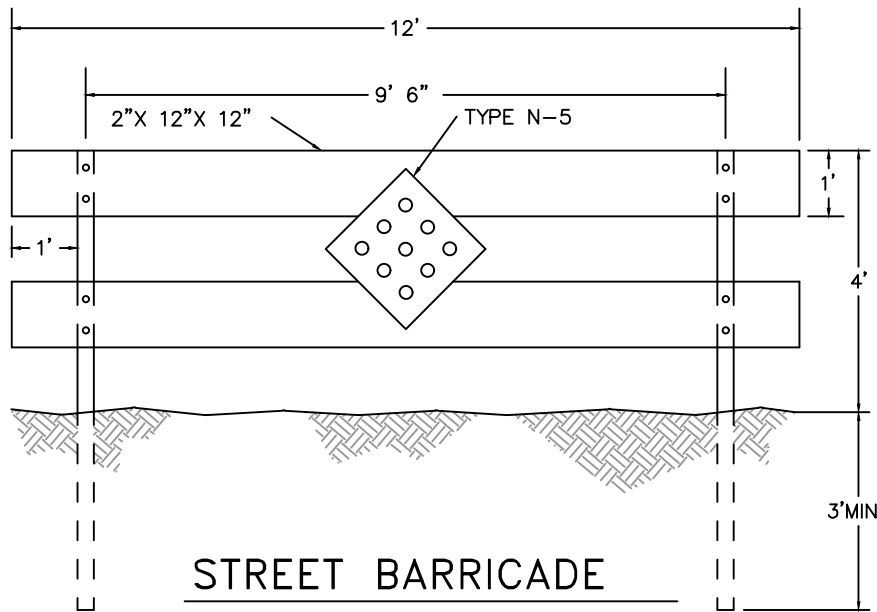

STREET BARRICADE

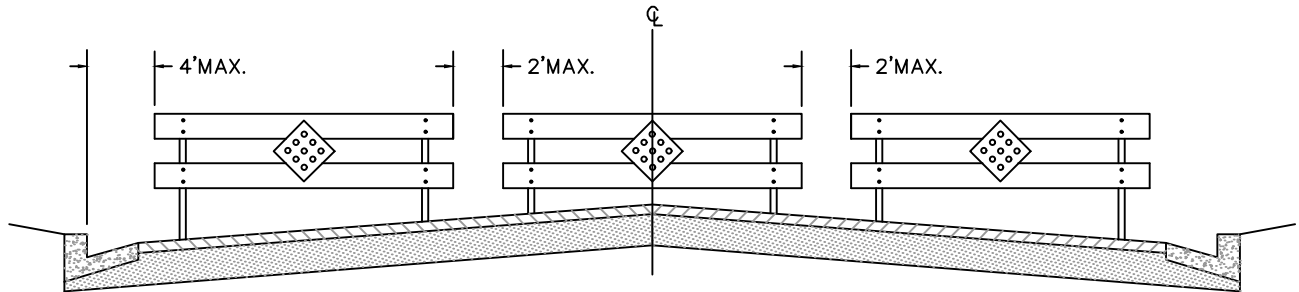

ST. WIDTH	NO. BARRICADES
64'	4 BARRICADES
40'	3 BARRICADES
30'	2 BARRICADES

NOTE:
ALL EXPOSED SURFACES TO BE PAINTED WITH 2 (TWO)
COATS OF 1145 SAFETY YELLOW PAINT (OR CITY
APPROVED EQUAL).

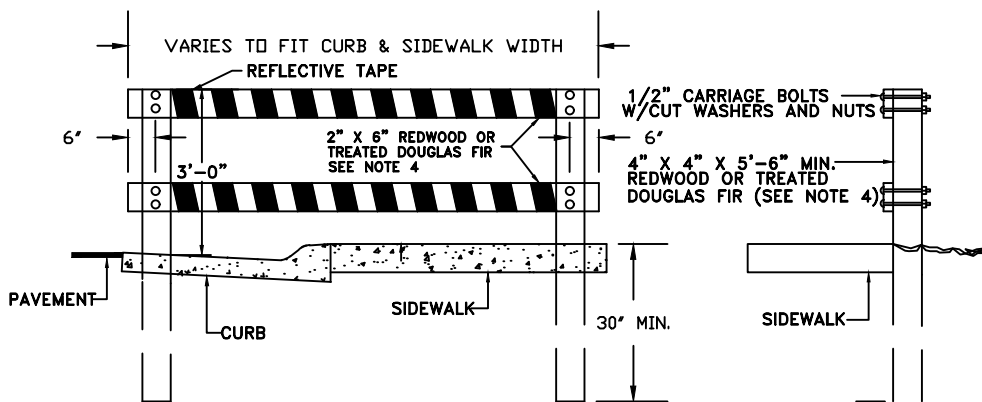

- NOTES:
1. SIDEWALK BARRICADE TO BE ERRECTED AT EACH LOCATION WHERE SATISFACTORY PROVISIONS CAN NOT BE MADE FOR PEDESTRIANS TO CONTINUE BEYOND THE TERMINUS OF A SIDEWALK.
 2. ALL CROSS MEMBER SURFACES TO BE PAINTED WITH TWO (2) COATS OF WHITE PAINT CONFORMING TO SECTION 91-3.02 OF CALTRANS SPECIFICATIONS. 6" WHITE ORANGE REFLECTIVE TAPE TO BE PLACED IN A DIAGONAL PATTERN
 4. WOOD SHALL BE IN CONFORMANCE WITH SECTION 56-2.02B OF THE STATE OF CALIFORNIA STANDARD SPECIFICATIONS.

SIDEWALK BARRICADE



APPROVED _____ DATE _____

DATE	REVISIONS	BY

STANDARD DETAIL 108

BARRICADES
CITY OF MARYSVILLE
PUBLIC WORKS DEPARTMENT

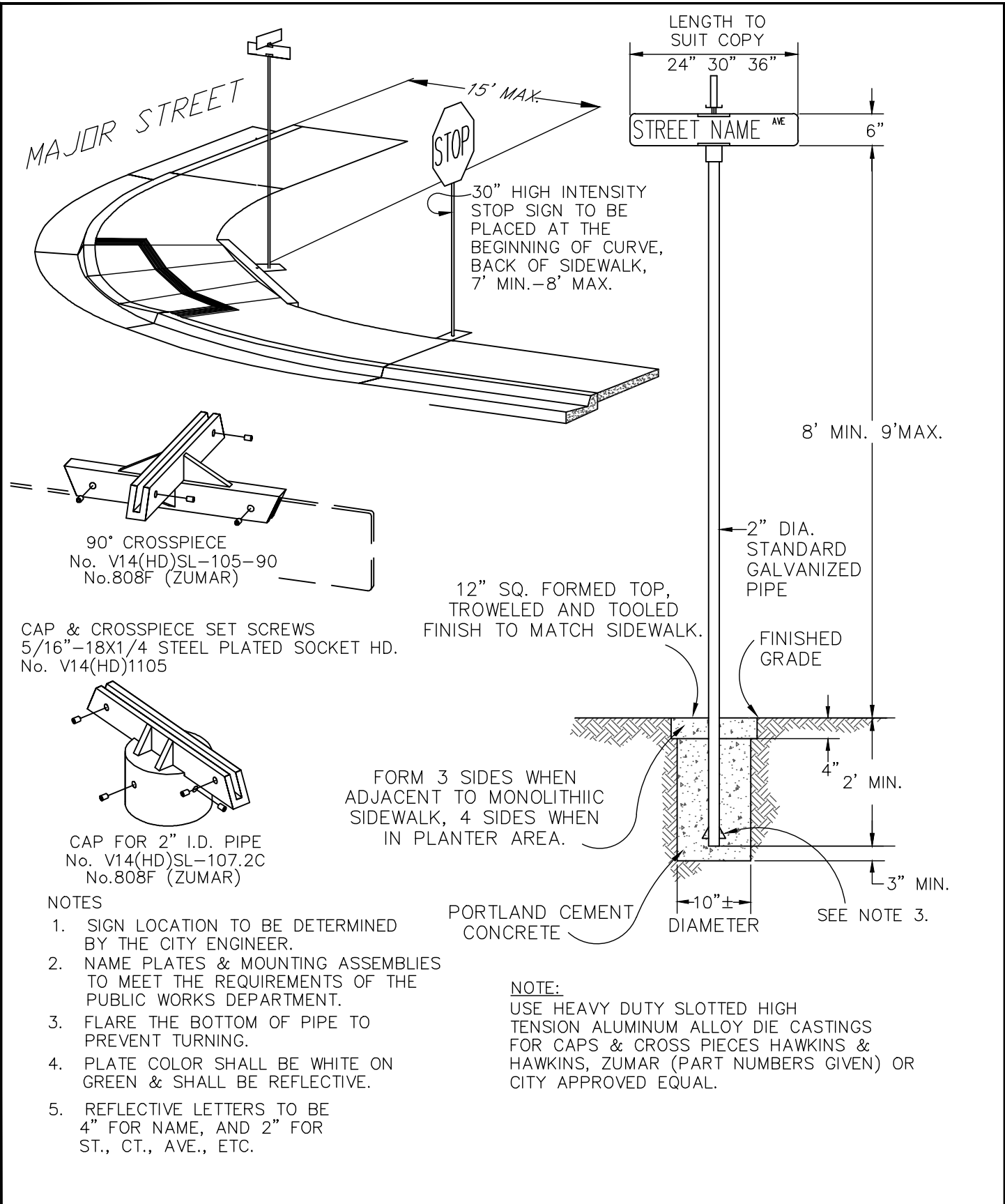

APPROVED		DATE
DATE	REVISIONS	BY

STANDARD DETAIL 109

STREET SIGNS

CITY OF MARYSVILLE

PUBLIC WORKS DEPARTMENT

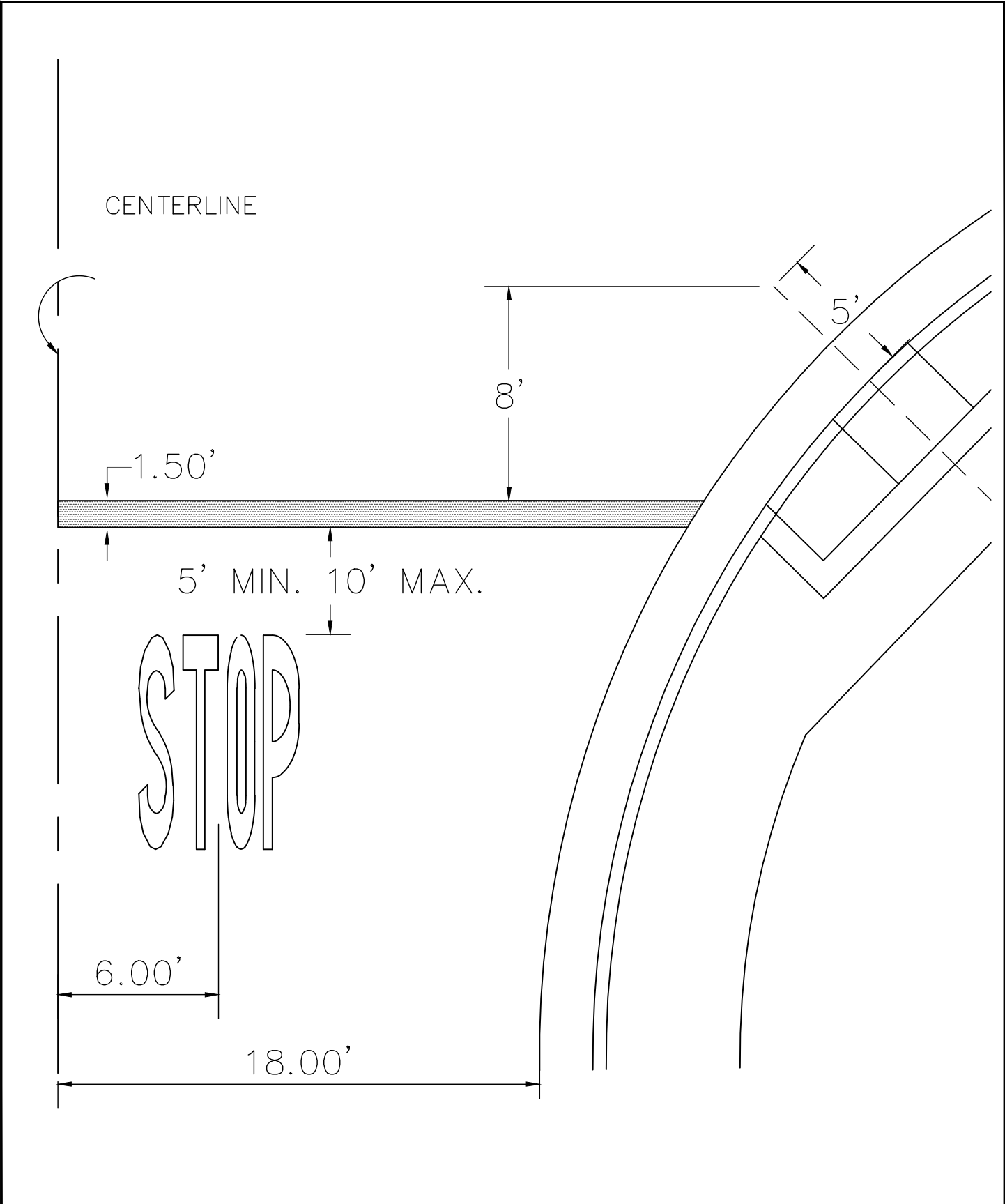

APPROVED		DATE
DATE	REVISIONS	BY

STANDARD DETAIL 110

STOP BAR PLACEMENT

CITY OF MARYSVILLE

PUBLIC WORKS DEPARTMENT

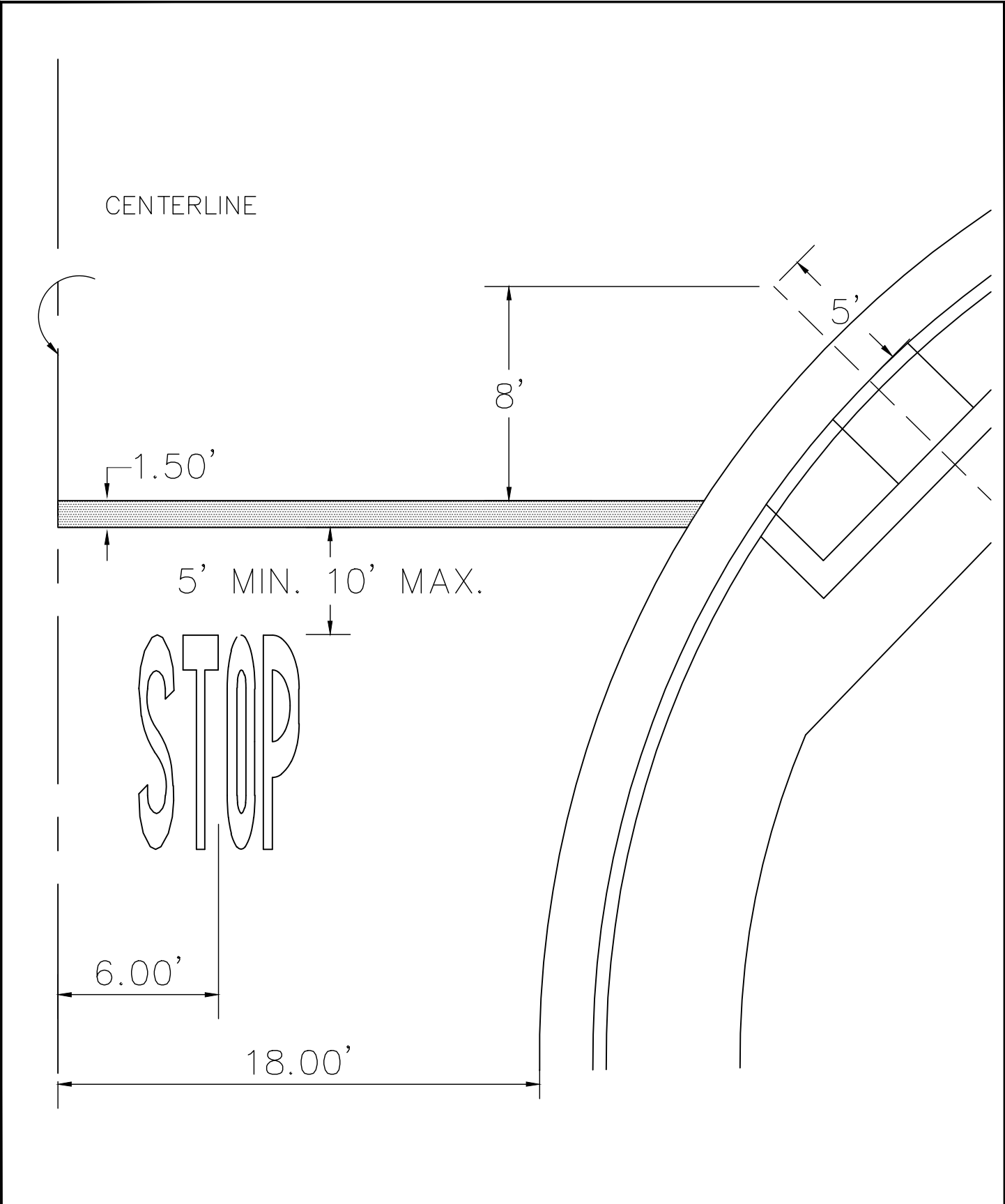

APPROVED		DATE
DATE	REVISIONS	BY

STANDARD DETAIL 110

STOP BAR PLACEMENT

CITY OF MARYSVILLE

PUBLIC WORKS DEPARTMENT

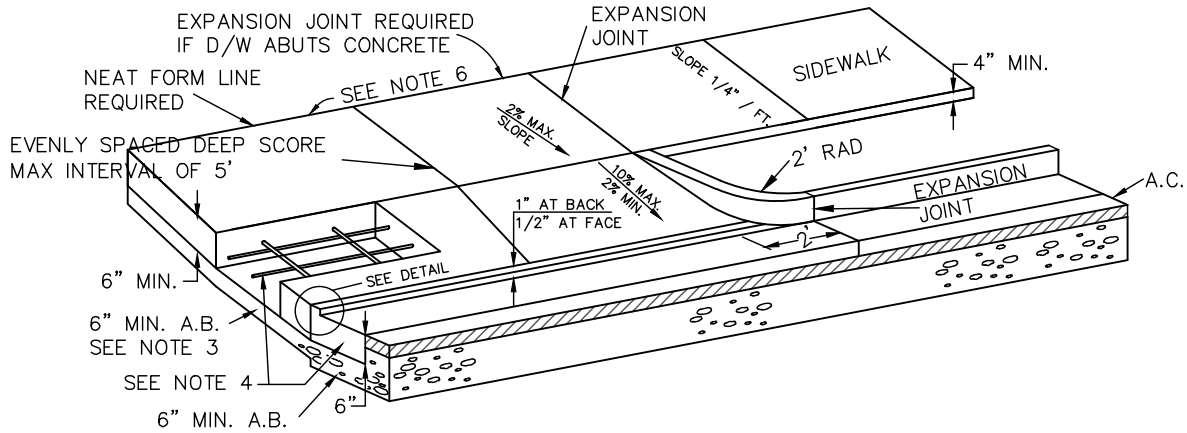

PARKWAYS 4' & GREATER

NOTES:

1. ALL CONCRETE REMOVALS SHALL BE TO NEAT SAW CUT LINES.
2. 90% RELATIVE COMPACTION REQUIRED ON SUBGRADE.
3. 1" ADDITIONAL CONCRETE THICKNESS MAY BE SUBSTITUTED FOR 4" REQUIRED OF THE CLASS 2 A.B.
4. ALL DRIVEWAYS SHALL HAVE 2 NO. 4 REBARS 12" O.C. IN THE GUTTER AND NO. 4 REBARS 18" O.C. THROUGHOUT THE APPROACH.
5. D/W APPROACH SHALL BE POURED SEPARATELY WITH CURB UNLESS OTHERWISE APPROVED BY THE ENGR.
6. ON SITE GRADING MAY BE REQUIRED TO ELIMINATE EXCESSIVE GRADE CHANGE AND TO MAINTAIN SUITABLE DRAINAGE.
7. MAXIMUM CURB OPENING MAY BE INCREASED DUE TO SPECIAL CONDITIONS ON APPROVAL OF CITY ENGINEER.
8. ALL CURB & GUTTER REPLACEMENTS REQUIRE THE REMOVAL & REPLACEMENT OF ADJACENT 3' STRIP OF AC.

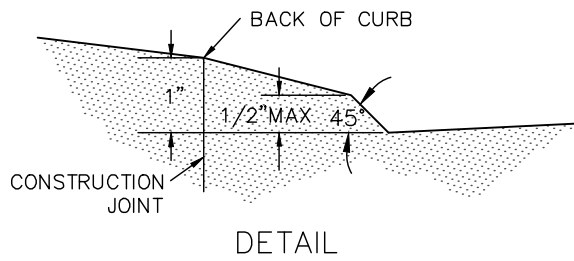

APPROVED _____ DATE _____

DATE	REVISIONS	BY

STANDARD DETAIL 111

**ALTERNATE DRIVEWAY
CITY OF MARYSVILLE
PUBLIC WORKS DEPARTMENT**

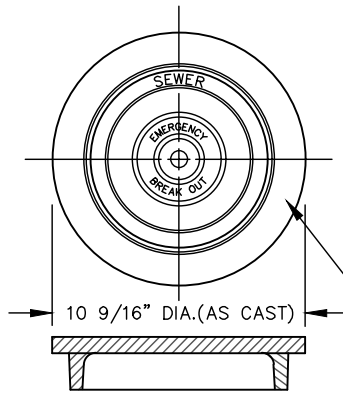

COVER DETAIL

- (1) FOR 6" SEWER MAIN USE D AND L SUPPLY 9 1/2" TRAFFIC VALVE BOX TYPE K 6016 OR APPROVED EQUAL MARKED "SEWER"
- (2) FOR 8" 10" AND 12" SEWER MAINS USE TEICHERT CLEAN-OUT ASSEMBLY H-8026-R1 & H-8026-01 OR EQUAL MARKED "SEWER"

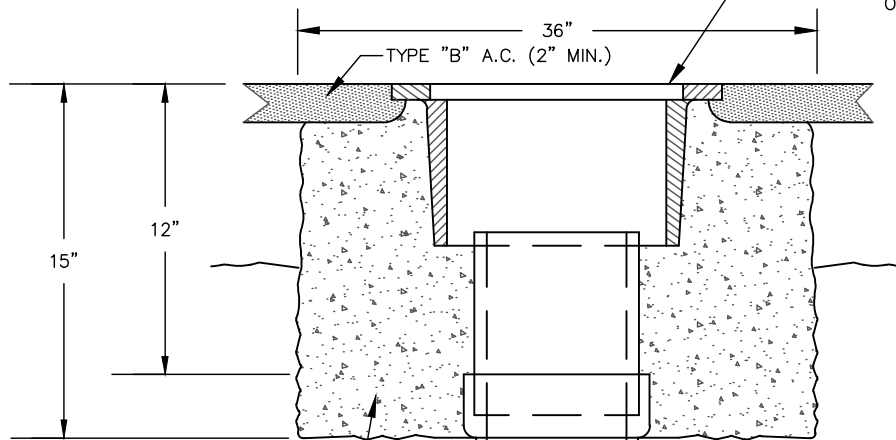

CONCRETE JACKET

45° LONG RADIUS BEND

VARIABLE

45° LONG RADIUS BEND



APPROVED _____ DATE _____

DATE	REVISIONS	BY

STANDARD DETAIL 201

**SANITARY SEWER CLEANOUT
CITY OF MARYSVILLE
PUBLIC WORKS DEPARTMENT**

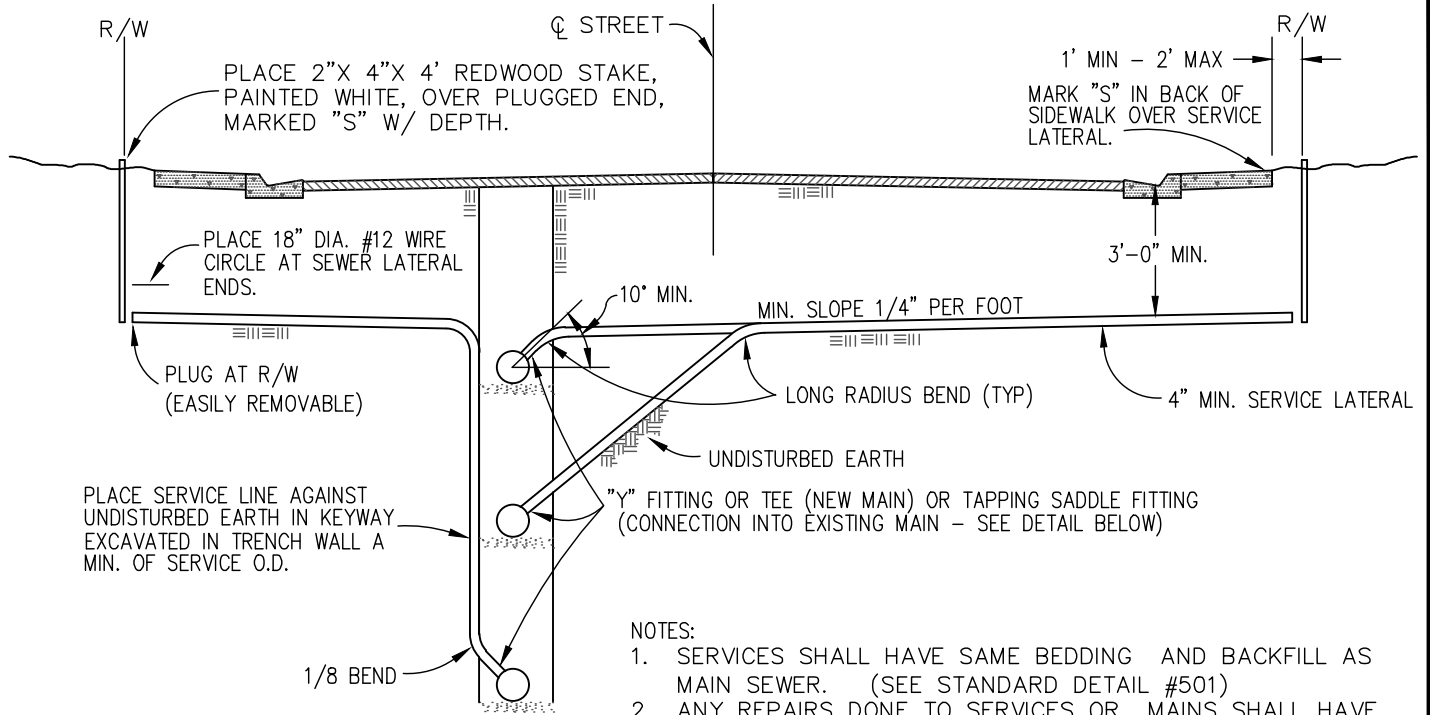

PLACE SERVICE LINE AGAINST UNDISTURBED EARTH IN KEYWAY EXCAVATED IN TRENCH WALL A MIN. OF SERVICE O.D.

NOTES:

1. SERVICES SHALL HAVE SAME BEDDING AND BACKFILL AS MAIN SEWER. (SEE STANDARD DETAIL #501)
2. ANY REPAIRS DONE TO SERVICES OR MAINS SHALL HAVE COMPRESSION COUPLINGS WITH STAINLESS STEEL SHEAR RINGS.
3. ALL SERVICES AND MAINS WITHIN THE CITY RIGHT-OF-WAY SHALL BE SDR-26 PVC OR VITRIFIED CLAY PIPE.
4. PIPE FOR MAIN AND SERVICES SHALL BE FUSION BONDED EPOXY DUCTILE IRON PIPE WHEN COVER IS 3' OR LESS OR SLURRY ENCASED AS APPROVED BY THE CITY ENGINEER.

TAPPING SADDLE
(CONNECTED TO PIPE W/STAINLESS STEEL STRAP)
SEALTITE OR CITY APPROVED EQUAL.

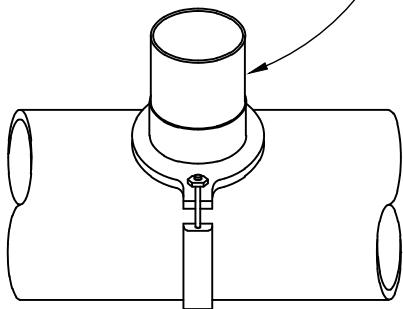

TAPPING COLLAR WYE SADDLE
(GROUT TO PIPE)

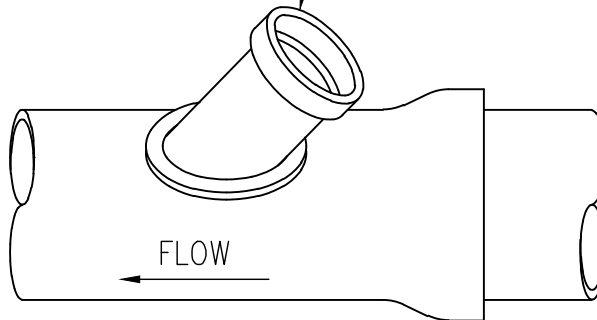

GROUT COLLAR
TO PIPE

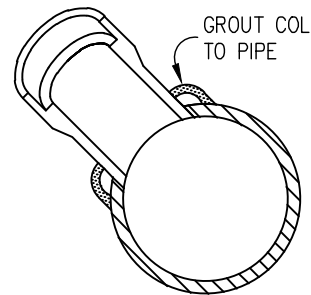

APPROVED _____ DATE _____

DATE	REVISIONS	BY

STANDARD DETAIL 202

SANITARY SEWER SERVICE & CONNECTION

**CITY OF MARYSVILLE
PUBLIC WORKS DEPARTMENT**

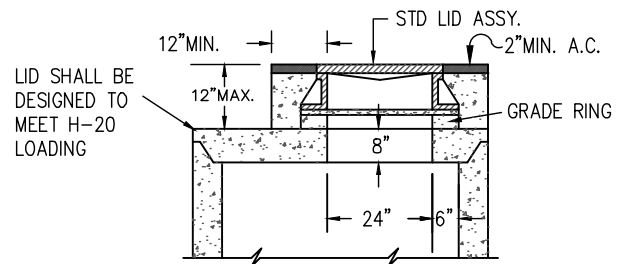
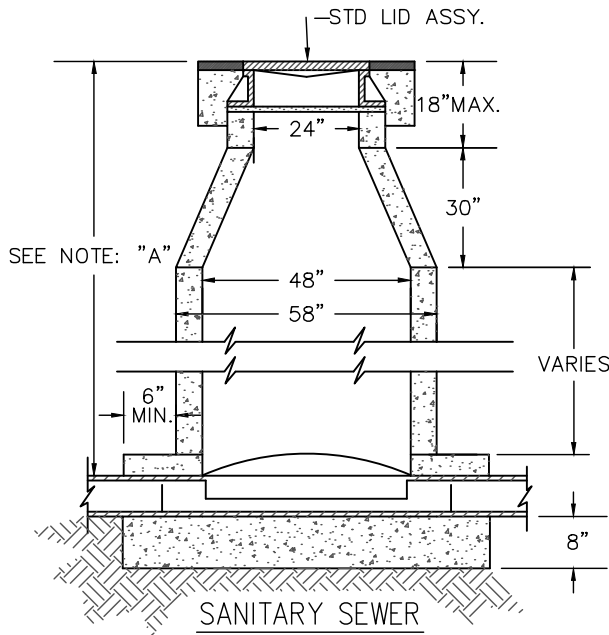

SHALLOW MANHOLE DETAIL
(FOR PIPES WITH LESS THAN 4' COVER)

NOTES:
A.) FOR PIPES WITH LESS THAN 4' COVER
USE THE SHALLOW MANHOLE DETAIL

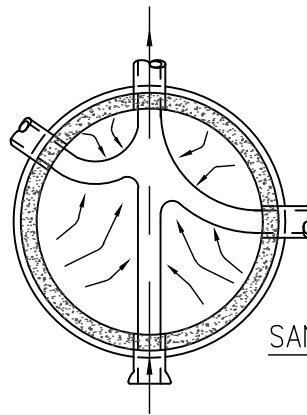

CHANNELIZATION FOR
SANITARY SEWER MANHOLES

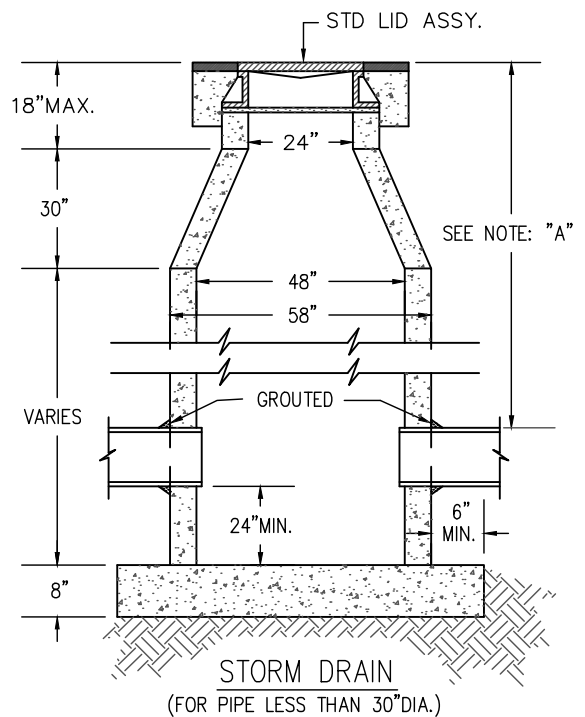
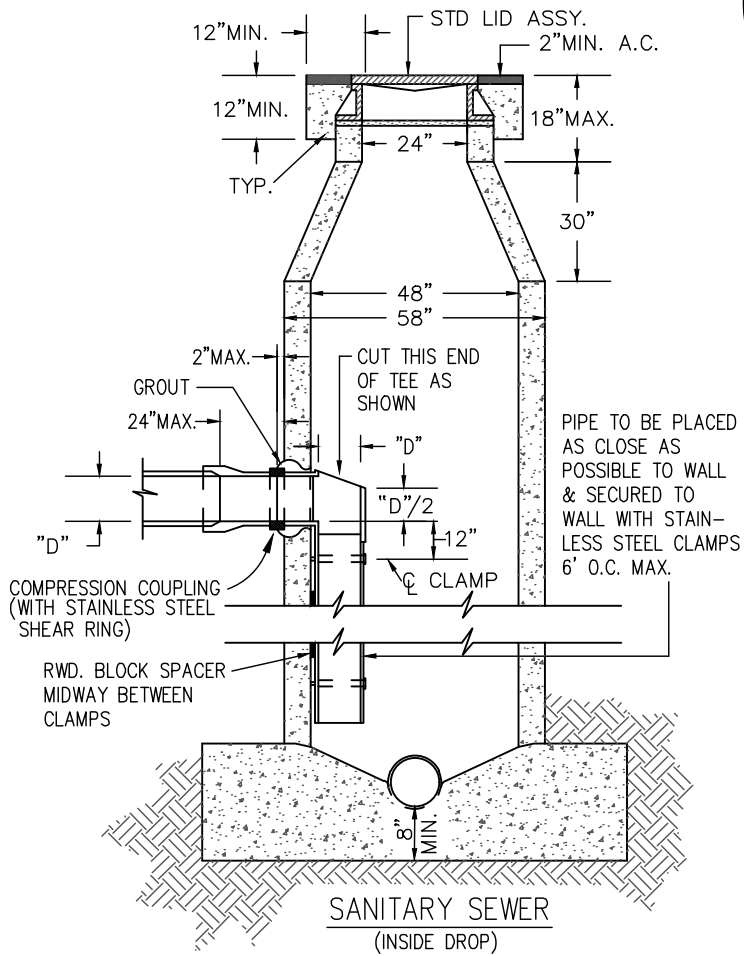

APPROVED _____ DATE _____

DATE	REVISIONS	BY

STANDARD DETAIL 203

SANITARY SEWER & STORM DRAIN MANHOLE

**CITY OF MARYSVILLE
PUBLIC WORKS DEPARTMENT**

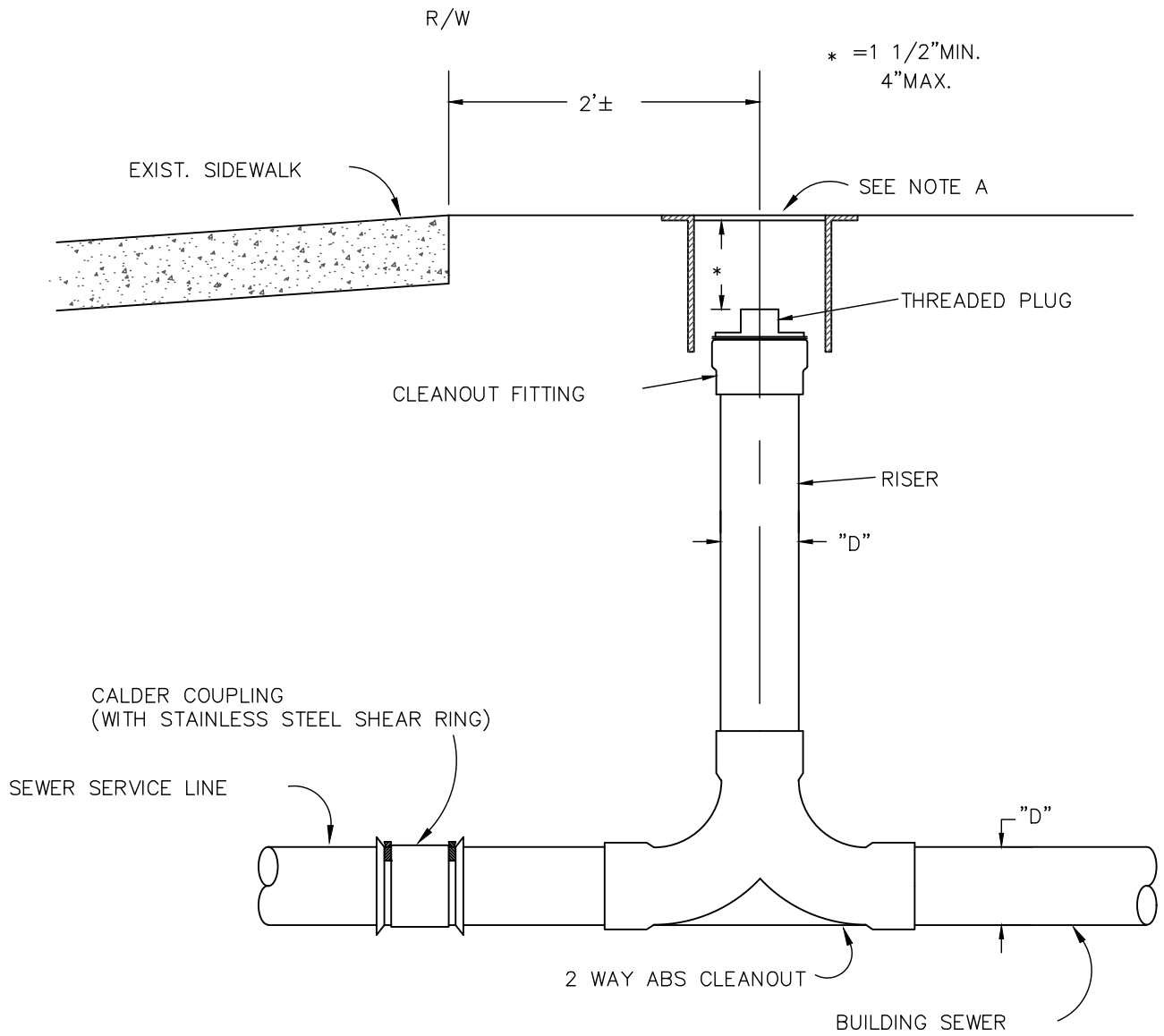

NOTE A:
 WHEN INSTALLED IN DRIVEWAY USE D AND L SUPPLY
 9 1/2" TRAFFIC VALVE BOX TYPE 80-60-03 OR
 APPROVED EQUAL MARKED SEWER - WHEN INSTALLED
 IN LAWN OR PLANTER USE FORNI CONCRETE VALVE
 BOX TYPE TF-18 MARKED SEWER.



APPROVED		DATE	
DATE	REVISIONS		BY

STANDARD DETAIL 204
SANITARY SEWER SERVICE CLEANOUT
CITY OF MARYSVILLE
PUBLIC WORKS DEPARTMENT

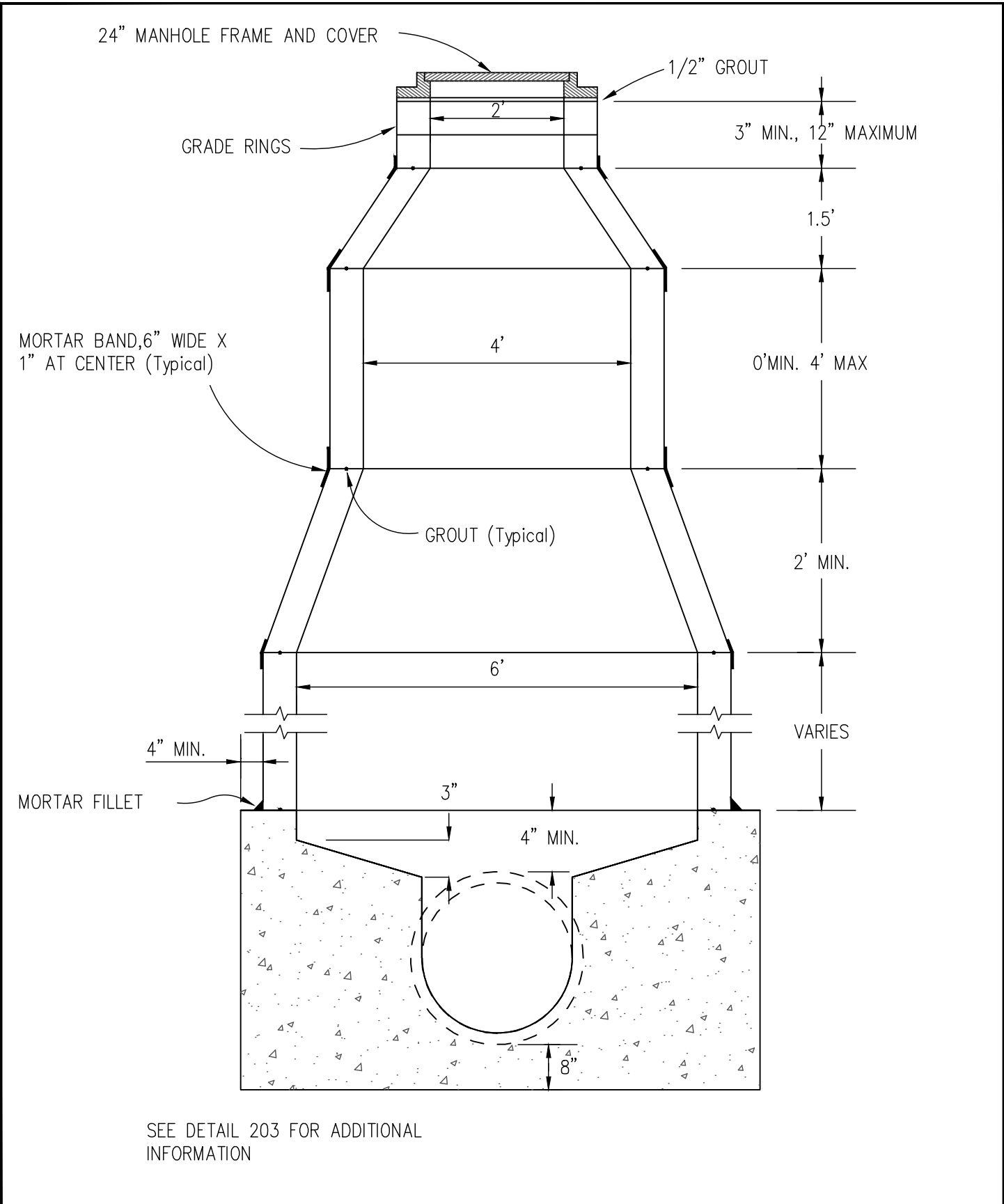

APPROVED		DATE
DATE	REVISIONS	BY

STANDARD DETAIL 205

SANITARY SEWER SPECIAL MANHOLE

CITY OF MARYSVILLE

PUBLIC WORKS DEPARTMENT

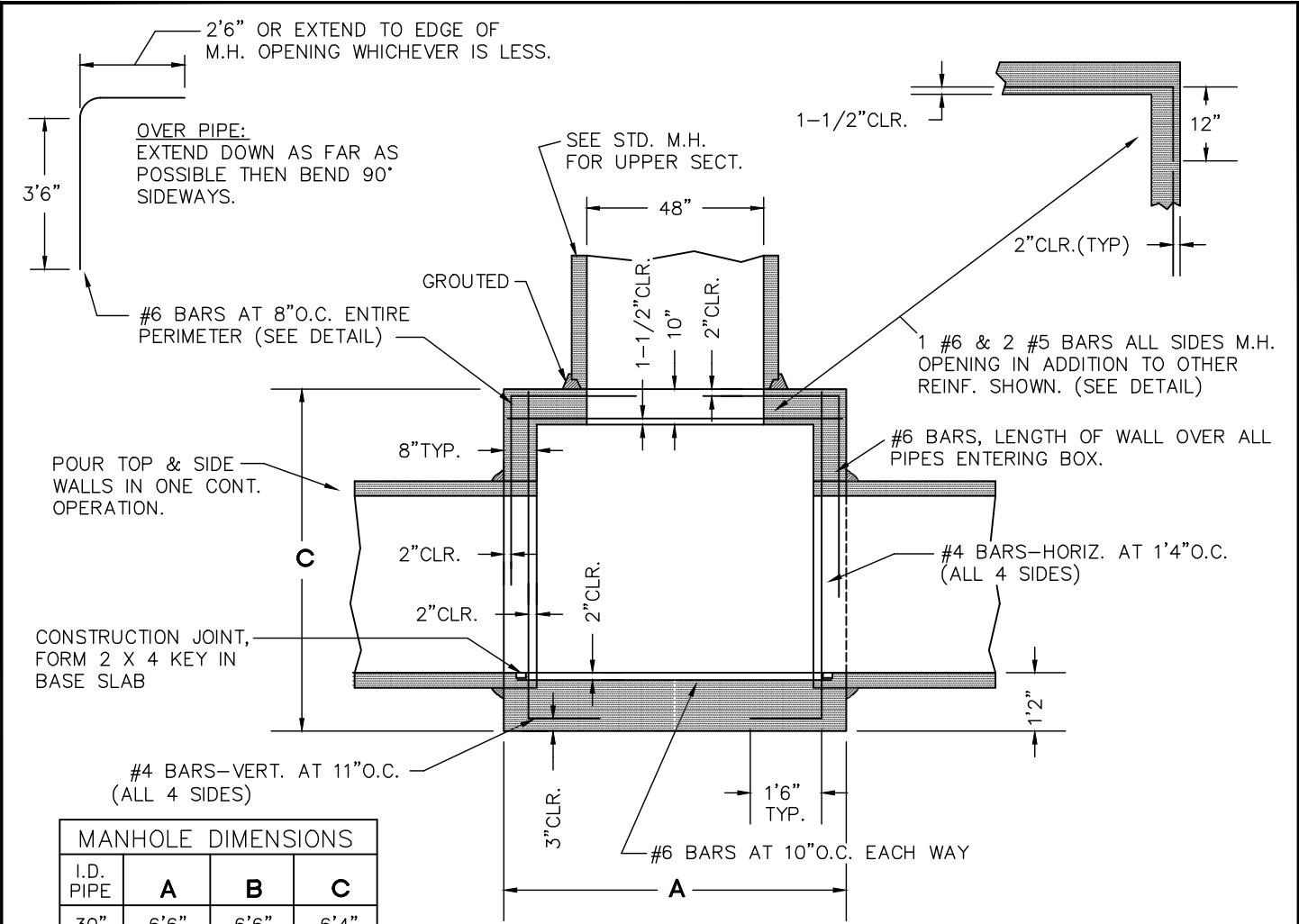

MANHOLE DIMENSIONS			
I.D. PIPE	A	B	C
30"	6'6"	6'6"	6'4"
36"	6'6"	6'6"	6'4"
42"	6'6"	6'6"	6'4"
48"	7'0"	7'0"	7'0"
54"	7'10"	8'0"	7'6"
60"	8'0"	8'6"	8'0"
72"	9'0"	9'8"	9'0"

SECTION X-X

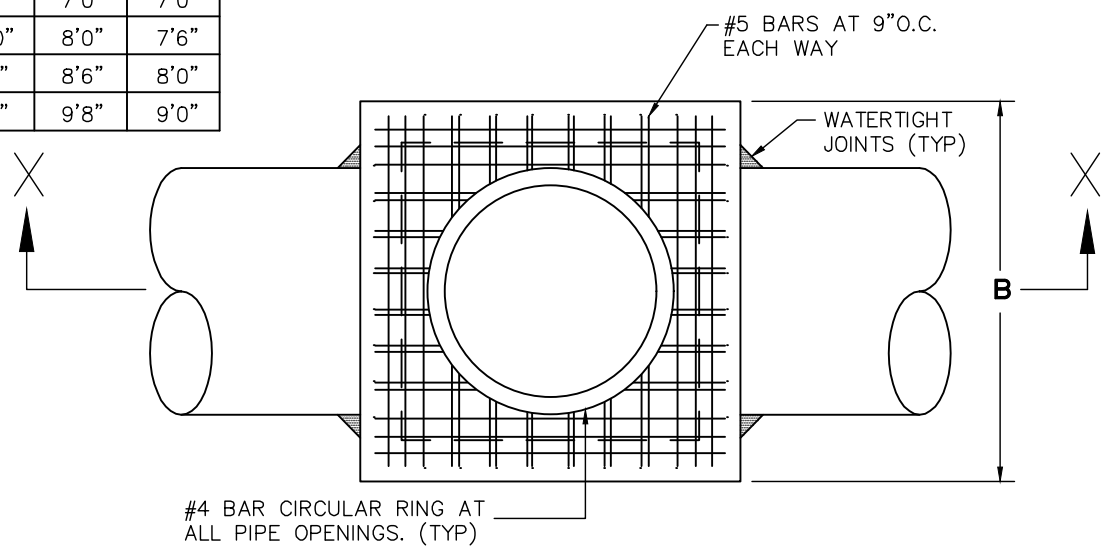

APPROVED		DATE	
DATE	REVISIONS		BY

STANDARD DETAIL 301

JUNCTION BOX FOR 30" PIPES

CITY OF MARYSVILLE

PUBLIC WORKS DEPARTMENT

MANHOLE DIMENSIONS									
I.D. PIPE	A	B	C	D	E	F	G	H	I
30"	5'0"	2'6"	5"	1'3"	3'9"	2'6"	3"	8"	7"
36"	5'0"	3'0"	4-1/2"	1'0"	4' 3-1/2"	3'0"	3-1/2"	8"	7-1/2"
42"	5'0"	3'6"	5"	9"	4'10"	3'6"	4"	8"	8"
48"	5'8"	4'0"	6"	10"	5'5"	4'0"	5"	8"	9"
54"	6'3"	4'6"	6-1/2"	10-1/2"	5' 11-1/2"	4'6"	5-1/2"	8"	9-1/2"
84"	9'0"	7'0"	8"	1'0"	8'7"	7'0"	7"	8"	11"
96"	10'2"	8'0"	9"	1'1"	9'9"	8'0"	7"	8"	1'1"

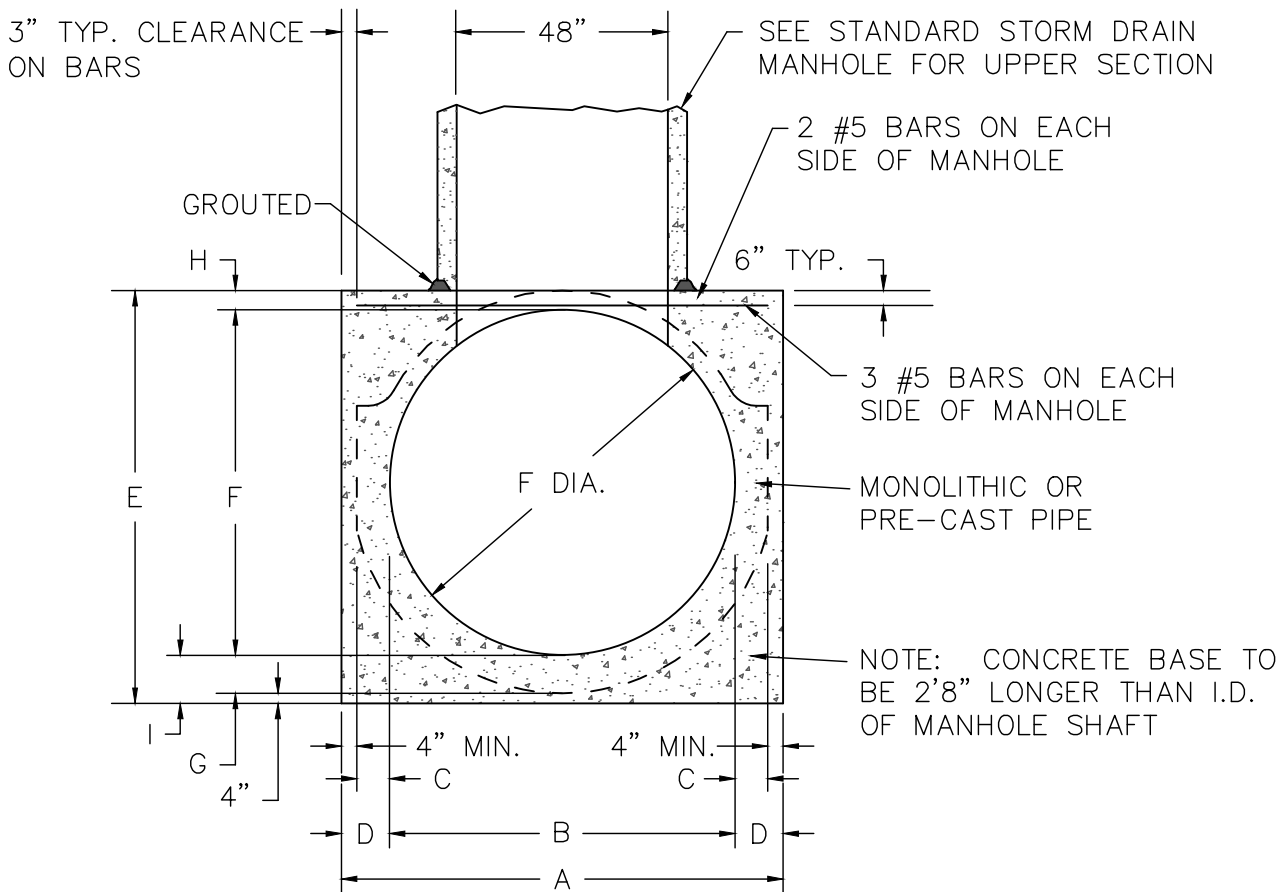

APPROVED		DATE	
DATE	REVISIONS		BY

STANDARD DETAIL 302

MANHOLE FOR PIPES 30 INCH & LARGER

CITY OF MARYSVILLE

PUBLIC WORKS DEPARTMENT

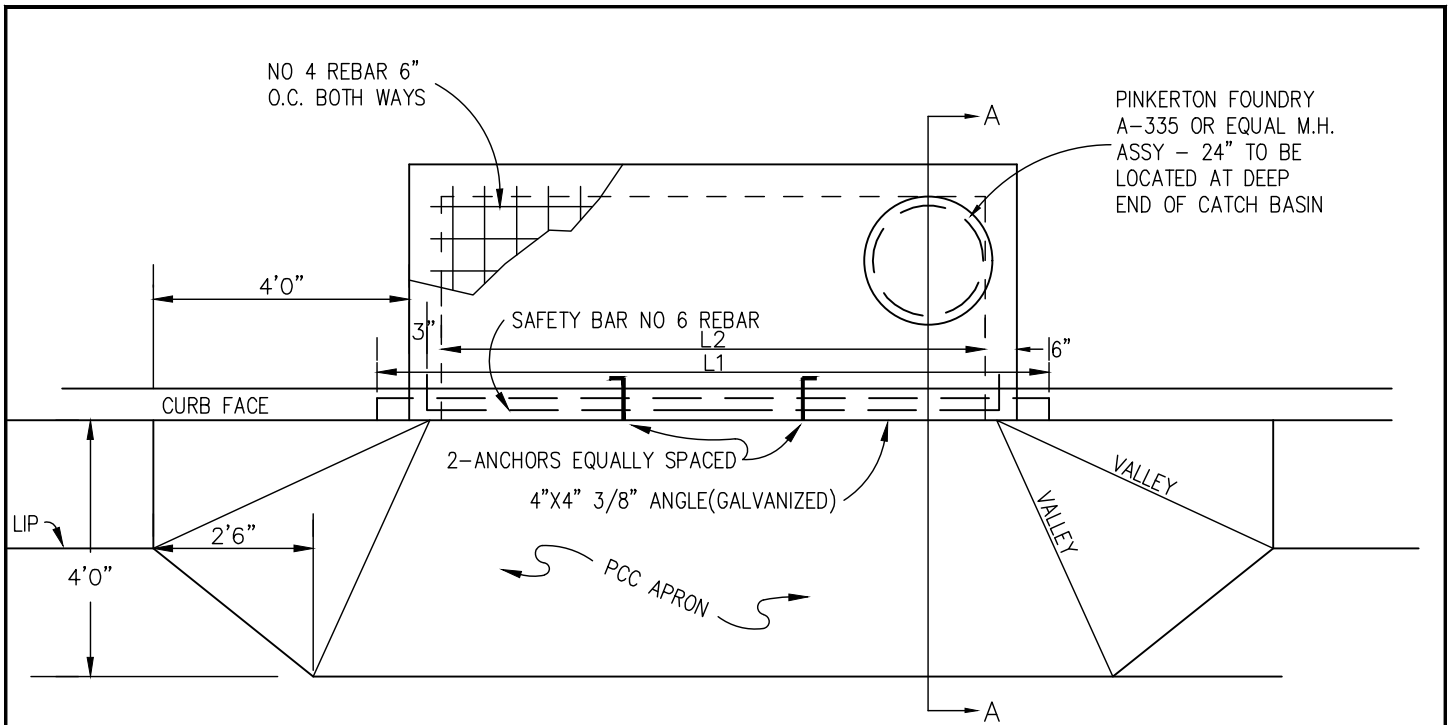

PINKERTON FOUNDRY
 A-335 OR EQUAL M.H.
 ASSY - 24" TO BE
 LOCATED AT DEEP
 END OF CATCH BASIN

SECT. A-A

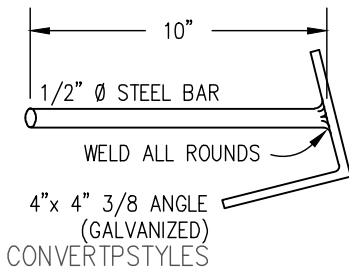
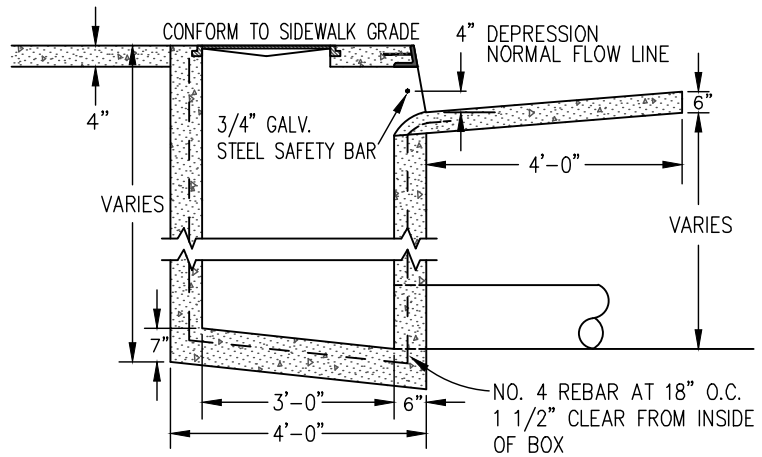

SCHEDULE		
STYLE	L ₁	L ₂
TYPE "A"	9'-6"	7'
TYPE "B"	7'-6"	5'

NOTE: A PRECAST UNIT MEETING THESE MINIMUM STANDARDS MAY BE SUBSTITUTED UPON PRIOR APPROVAL OF THE CITY ENGINEER.

STANDARD DETAIL 303

CATCH BASIN
CITY OF MARYSVILLE
PUBLIC WORKS DEPARTMENT



APPROVED _____ DATE _____

DATE	REVISIONS	BY

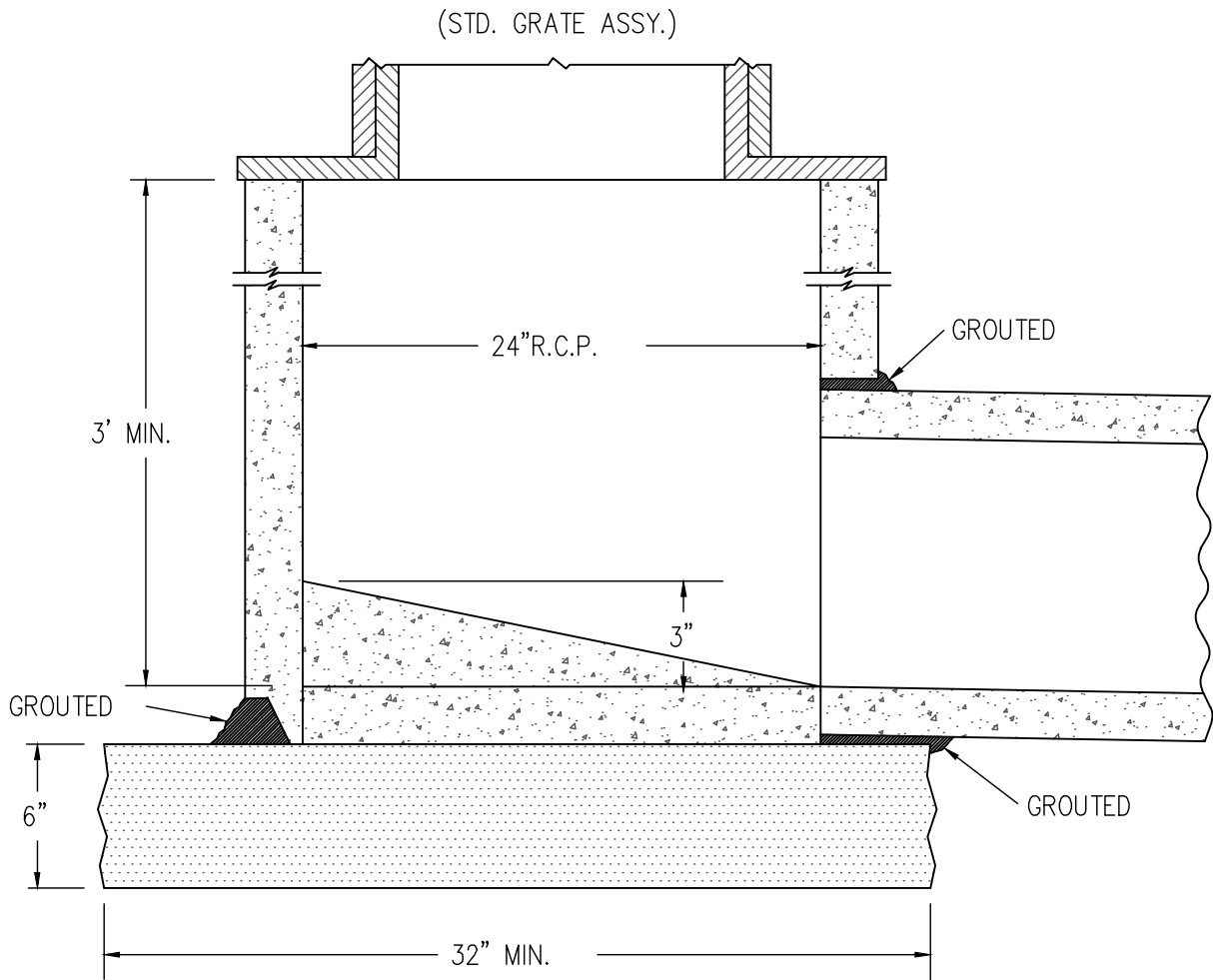

APPROVED _____ DATE _____

DATE	REVISIONS	BY

STANDARD DETAIL 305

DROP INLET
CITY OF MARYSVILLE
PUBLIC WORKS DEPARTMENT

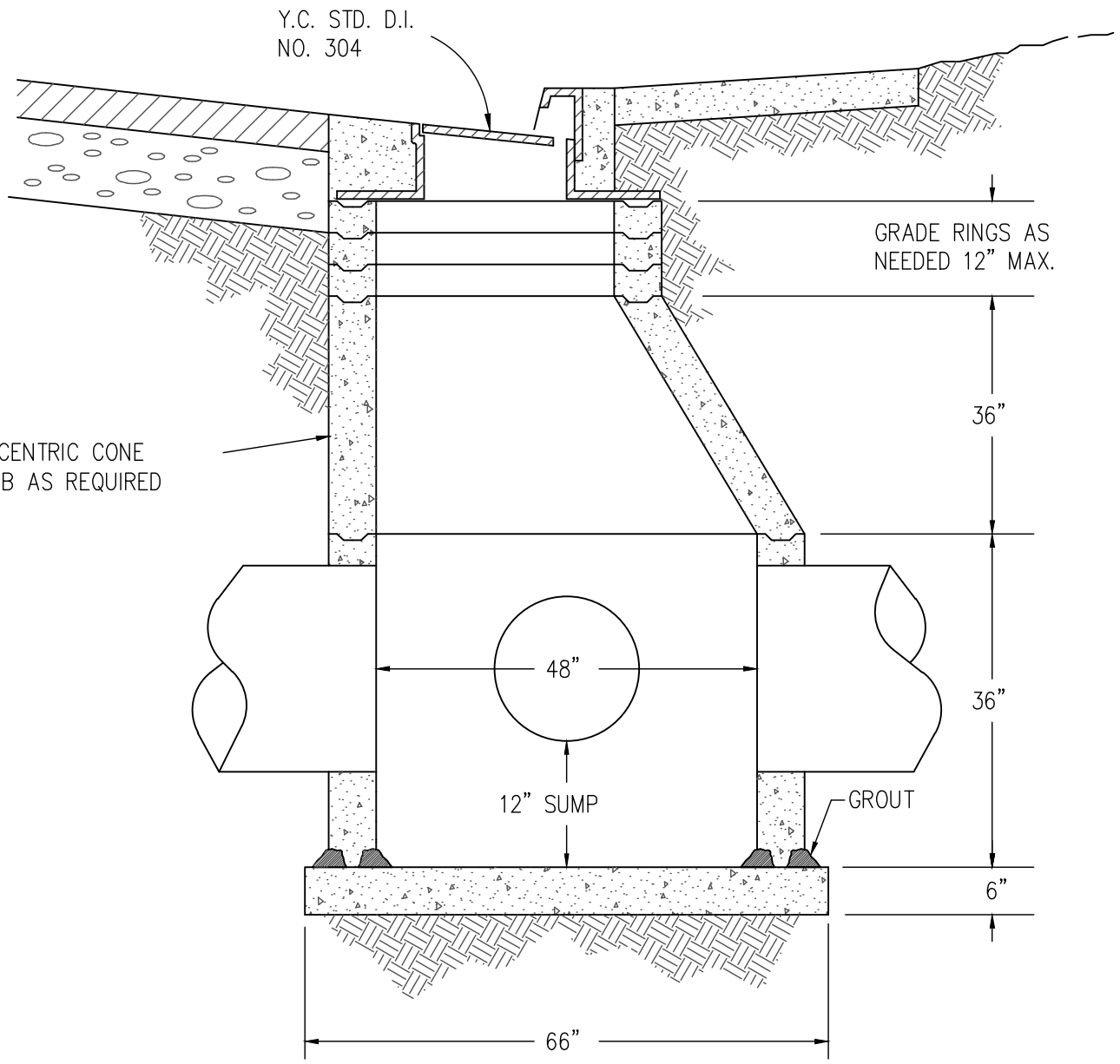

APPROVED		DATE	
DATE	REVISIONS	BY	

STANDARD DETAIL 306
JUNCTION DROP INLET DETAIL
CITY OF MARYSVILLE
PUBLIC WORKS DEPARTMENT

NOTE:
 MANHOLE FRAME & COVER TEICHERT NO. A-1024,
 D & L SUPPLY NO. A-1024, SOUTH BAY FOUNDRY
 NO. SBF 1900 SAC OR CITY APPROVED EQUAL.

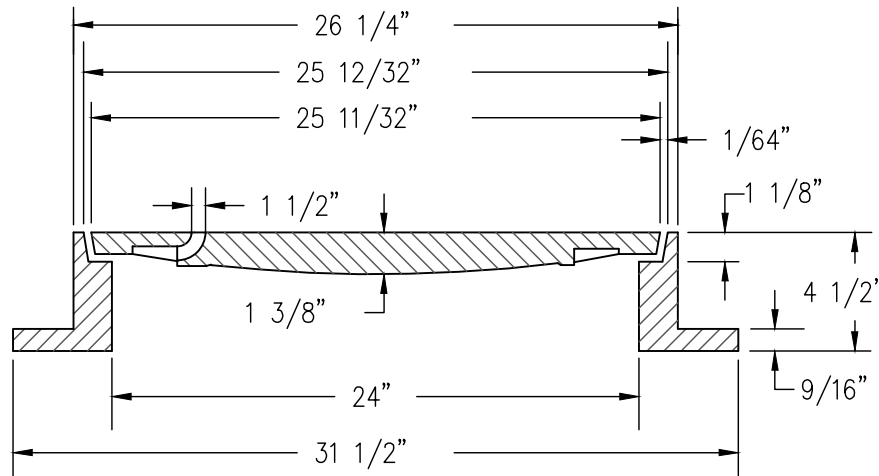
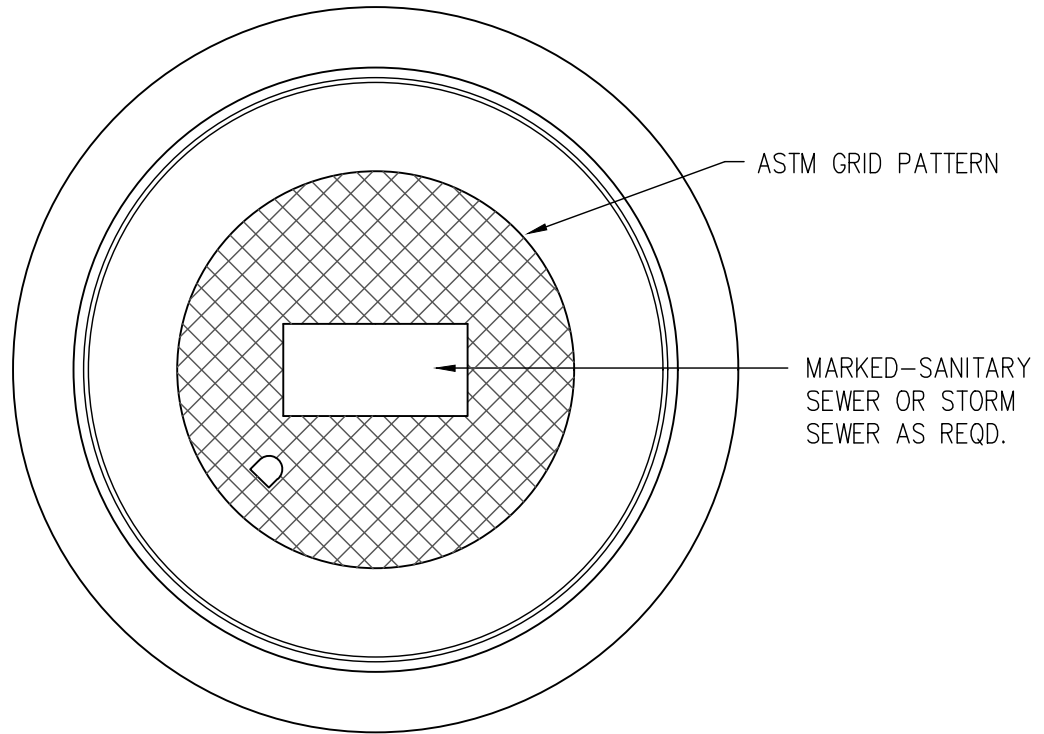

APPROVED _____ DATE _____

DATE	REVISIONS	BY

STANDARD DETAIL 307

MANHOLE FRAME & GRATE
 CITY OF MARYSVILLE
 PUBLIC WORKS DEPARTMENT

STD. CITY
6" BARRIER
CURB & GUTTER

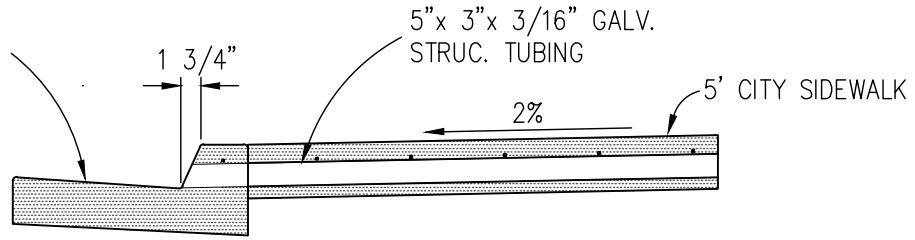

STRUCT. TUBING TO
BE CUT TO FIT CURB
ANGLE. COAT ENDS
W/MIN. 2 COATS
SHERWIN WILLIAMS
"GALVITE" OR EQUAL.

SECTION A-A

NOTE: DRAIN ASSEMBLY SHALL
BE FABRICATED AND HOT
DIP GALVANIZED.

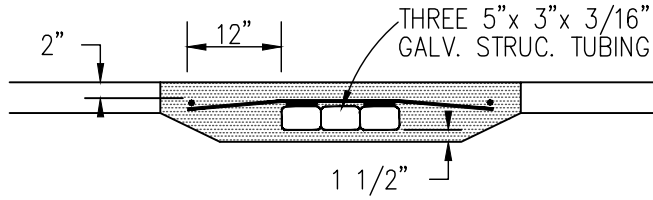

SECTION B-B

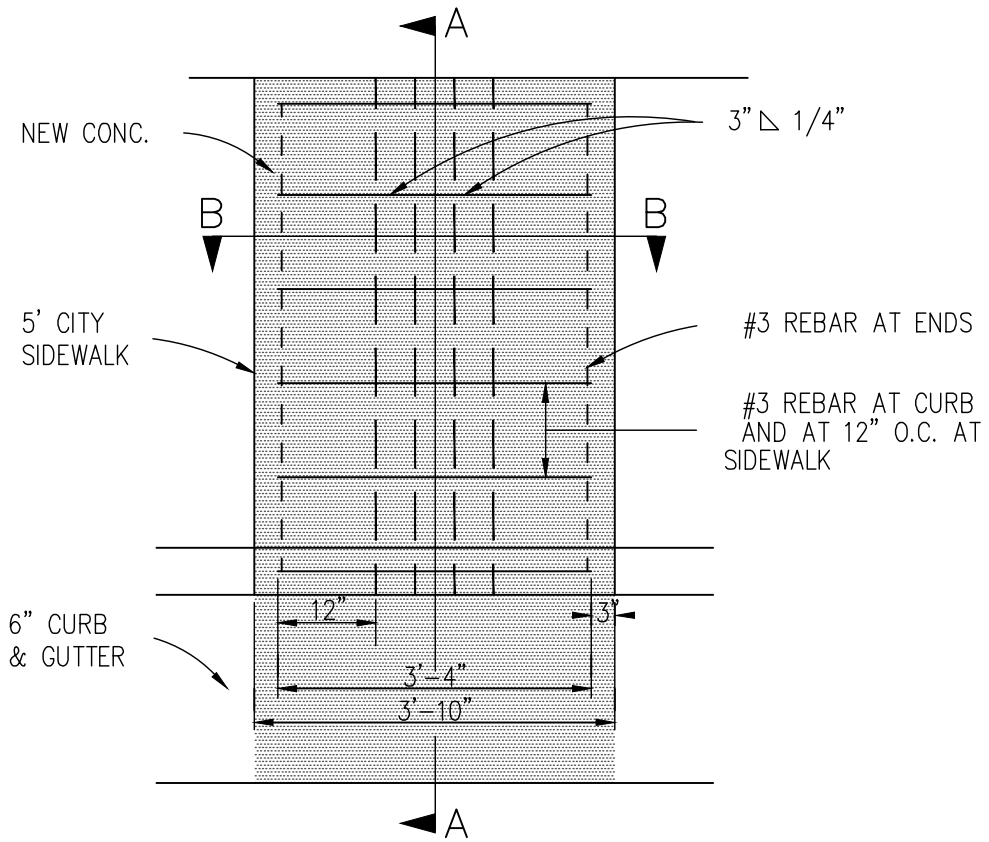

PLAN VIEW



APPROVED _____ DATE _____

DATE	REVISIONS	BY

STANDARD DETAIL 308

UNDER SIDEWALK DRAIN
CITY OF MARYSVILLE
PUBLIC WORKS DEPARTMENT

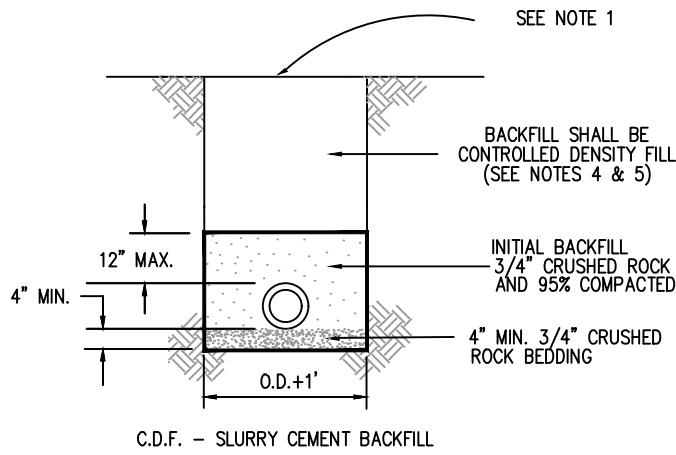
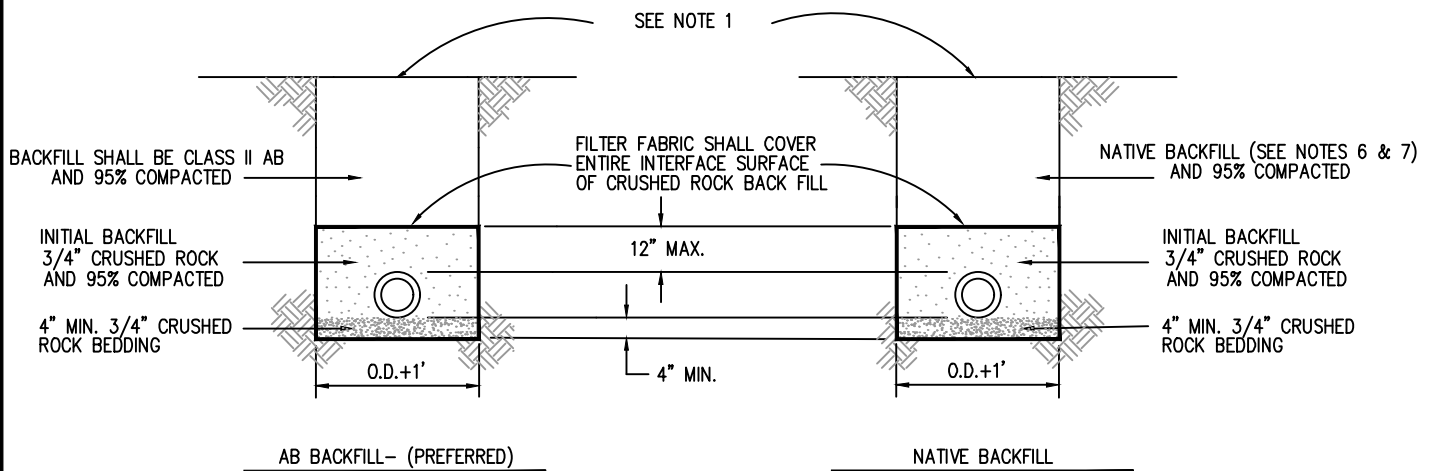

NOTES:

1. REFER TO STANDARD DETAIL 502 FOR SURFACE RESTORATION.
2. PIPE BEDDING AND INITIAL BACKFILL MAY BE REVISED TO SAND IF REQUIRED BY PIPE MANUFACTURER OR UTILITY. PIPE INITIAL BACKFILL MAY BE REVISED TO C.D.F. - SLURRY CEMENT IF IT IS BEING USED FOR FINAL BACKFILL.
3. ALL TRENCH WORK 5' AND DEEPER SHALL HAVE APPROVED SHORING, ALL IN ACCORDANCE WITH OSHA STANDARDS.
4. CONTROLLED DENSITY FILL (C.D.F. - SLURRY CEMENT) MUST CONFORM TO CALTRANS STANDARD SECTION 19 FOR 2 SACK SLURRY CEMENT AND A MIX DESIGN WILL BE SUBMITTED TO THE ENGINEER FOR APPROVAL.
5. THERE SHALL BE A 2 DAY WAITING PERIOD PRIOR TO SUBJECTING THE C.D.F. -SLURRY CEMENT BACKFILL TO TRAFFIC LOADS. THIS TIME PERIOD CAN BE REDUCED IF, IN THE OPINION OF THE ENGINEER, THE C.D.F. IS ADEQUATELY FIRM AND STABLE.
6. NATIVE MATERIAL MUST BE SUITABLE TO OBTAIN THE 95% COMPACTION REQUIRED AND A GEOTECHNICAL FIRM, APPROVED BY THE ENGINEER, SHALL SUPERVISE THE INSTALLATION AND PERFORM ALL REQUIRED TESTING.
7. NATIVE MATERIAL COMPACTION MAY BE REDUCED TO 90% IF GREATER THAN 3' FROM EP & NOT UNDER SIDEWALK.
8. MINIMUM COVER OVER UTILITIES SHALL BE 1' BELOW FINISHED SUBGRADE OR 2' BELOW FINAL GRADE, WHICHEVER IS GREATER.
9. CONTRACTOR SHALL PROVIDE COMPACTION TESTS BY AN INDEPENDENT GEOTECHNICAL FIRM TAKEN A MAXIMUM 200' APART ON LONGITUDINAL TRENCHES PRIOR TO PLACEMENT OF MATERIAL FOR HIGHER LIFTS. SUBSEQUENT TESTS SHALL BE MIDWAY BETWEEN PREVIOUS TEST SITES. MINIMUM OF 2 TESTS PER LIFT ON CROSS TRENCHES. THE TOP 1' OF SUBGRADE FOR ALL TRENCHES SHALL BE TESTED FOR COMPACTION REQUIREMENT IN ADDITION TO THE RANDOM SUBGRADE TEST SITES.
10. SAWCUT INITIAL TRENCH WIDTH, THEN 30 DAYS AFTER WORK HAS BEEN COMPLETED, SAWCUT OR GRIND THE ADDITIONAL WIDTH ON BOTH SIDES OF TRENCH IN ACCORDANCE WITH STANDARD DETAIL 502.



	APPROVED	DATE	
DATE	REVISIONS	BY	

STANDARD DETAIL 501

TRENCH BACKFILL

CITY OF MARYSVILLE

PUBLIC WORKS DEPARTMENT

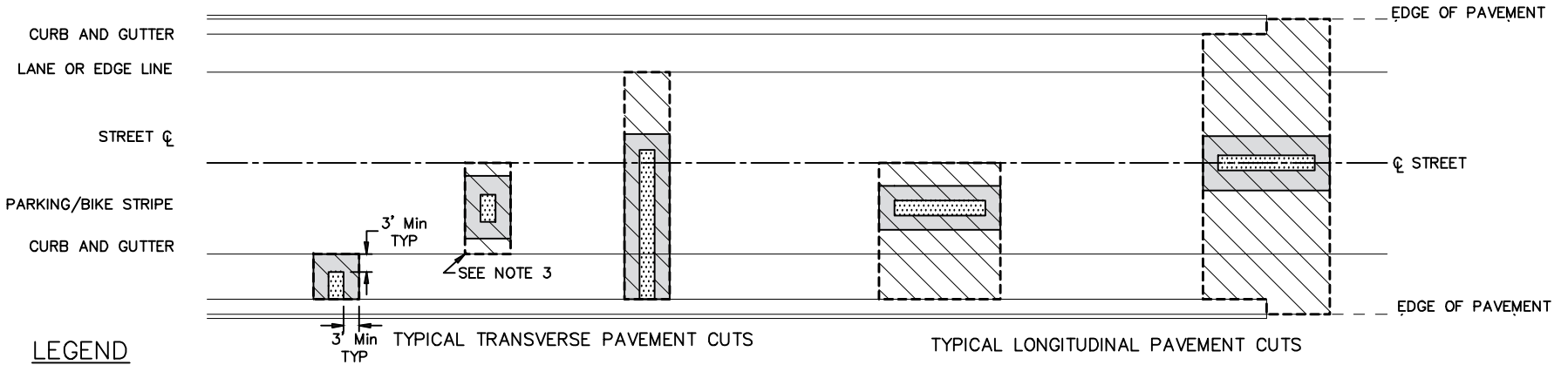

LEGEND



OVERLAY LIMITS FOR PAVEMENT 5 YEARS OLD AND NEWER
 WHEN PAVEMENT IS 5 YEARS OLD, OR LESS, A PAVEMENT PATCH IS REQUIRED TO THESE LIMITS. NO JOINTS OR REDUCTION IN AREA ARE ALLOWED. PAVEMENT REPLACEMENT IS REQUIRED TO THE NEXT ADJACENT CURB/EDGE OF PAVEMENT, PARKING OR LANE LINE WHENEVER A TRENCH OR DISTURBANCE OF ASPHALT OR SUPPORT MATERIAL EXTENDS BEYOND SUCH LINE. SEE NOTE 3 ON THIS PAGE.



OVERLAY LIMITS FOR PAVEMENT OLDER THAN 5 YEARS
 WHEN PAVEMENT IS OLDER THAN 5 YEARS, A PAVEMENT PATCH IS REQUIRED TO THESE LIMITS. NO JOINTS OR REDUCTION IN AREA ARE ALLOWED. PAVEMENT REPLACEMENT IS REQUIRED TO THE NEXT ADJACENT CURB, PARKING OR LANE LINE WHENEVER A TRENCH OR DISTURBANCE OF ASPHALT OR SUPPORT MATERIAL EXTENDS BEYOND SUCH LINE. SEE NOTE 3 ON THIS PAGE.



TRENCH LIMITS AT TOP OF PAVEMENT



T SECTION LIMITS (FULL DEPTH AC REPLACEMENT)

NOTES

1. FULL-DEPTH PAVEMENT PATCH JOINTS SHALL BE SEALED WITH CRAFCO POLYFLEX TYPE-1, OR EQUAL.
2. ALL CUTS SHALL BE PERPENDICULAR OR PARALLEL TO DIRECTION OF TRAVEL.
3. REMOVE ADDITIONAL PAVEMENT TO ADJACENT EXISTING PAVEMENT PATCH, MANHOLE, BOX, OR EDGE OF PAVEMENT IF THESE FEATURES ARE WITHIN 3 FEET OF FINAL SAW CUT.
4. SIDEWALK SHALL BE REMOVED TO EXISTING JOINTS OR SAW CUT AT EXISTING SCORE LINES. NEW CONCRETE SHALL BE SCORED TO MATCH EXISTING.

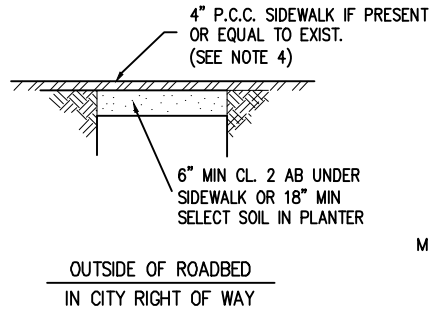

PLAN

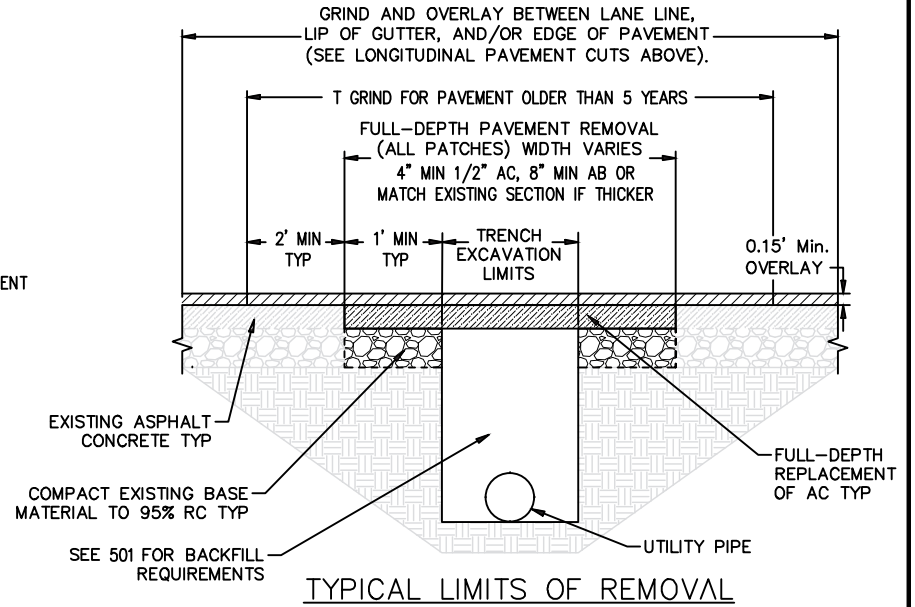

APPROVED _____ DATE _____

DATE	REVISIONS	BY

STANDARD DETAIL 502

**SURFACE RESTORATION
 CITY OF MARYSVILLE
 PUBLIC WORKS DEPARTMENT**

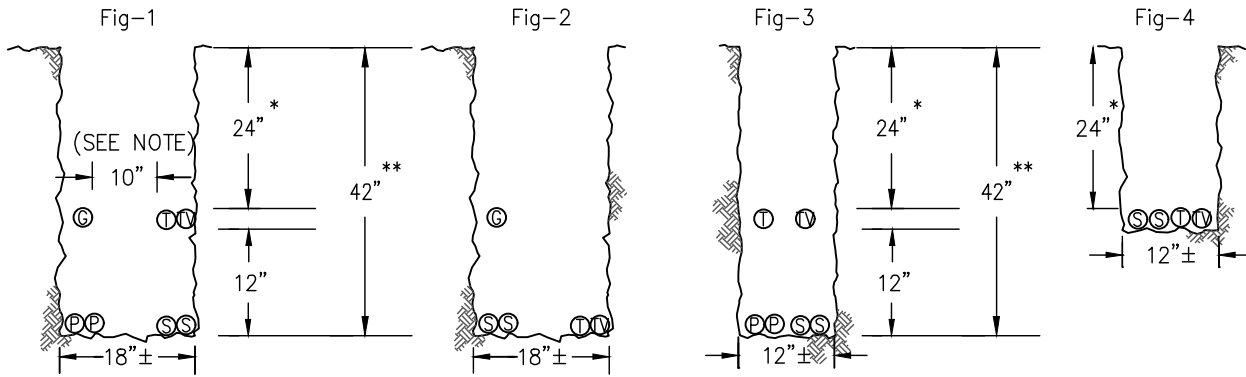

LEGEND

- (G) — GAS
- (P) — ELECT. PRIMARIES
- (S) — ELECT. SECONDARIES
- (T) — TELEPHONE
- (TV) — TELEVISION

- * — INCREASE TO 30" IN STREET AREA
- ** — INCREASE TO 48" IN STREET AREA

NOTE: SEPARATION MAY BE REDUCED TO NOT LESS THAN 6' WHEN NECESSARY, INSTEAD OF INCREASING TRENCH WIDTH.

TYPICAL SIDEWALK & STREET JOINT TRENCH CONFIGURATIONS

JOINT TRENCH OCCUPANCY GUIDE

Sect.	(G)	(P)	(S)	(T)	(TV)	Fig.
A	X	X	12" Trench Width			1
B	X	X	X	12" Trench Width		1
C	X	X	X	X		1
D	X	X		X		1
E	X		X	12" Trench Width		1
F	X		X	X		2
G	X	X			X	1
H	X		X		X	2
I	X			X		1

Sect.	(G)	(P)	(S)	(T)	(TV)	Fig.
J	X			X	X	1
K	X				X	1
L		X	X	36" Min. Cover		3
M		X	X	X		3
N		X		X		3
P		X		X	X	3
Q		X	X		X	3
R		X			X	3
S			X	X		4

Sect.	(G)	(P)	(S)	(T)	(TV)	Fig.
T			X		X	4
U				X	X	4
V	X	X	X	X	X	1
W	X		X	X	X	2
X		X	X	X	X	3
Y			X	X	X	4



APPROVED _____ DATE _____

DATE	REVISIONS	BY

STANDARD DETAIL 503

**JOINT TRENCH CONFIGURATIONS
CITY OF MARYSVILLE
PUBLIC WORKS DEPARTMENT**

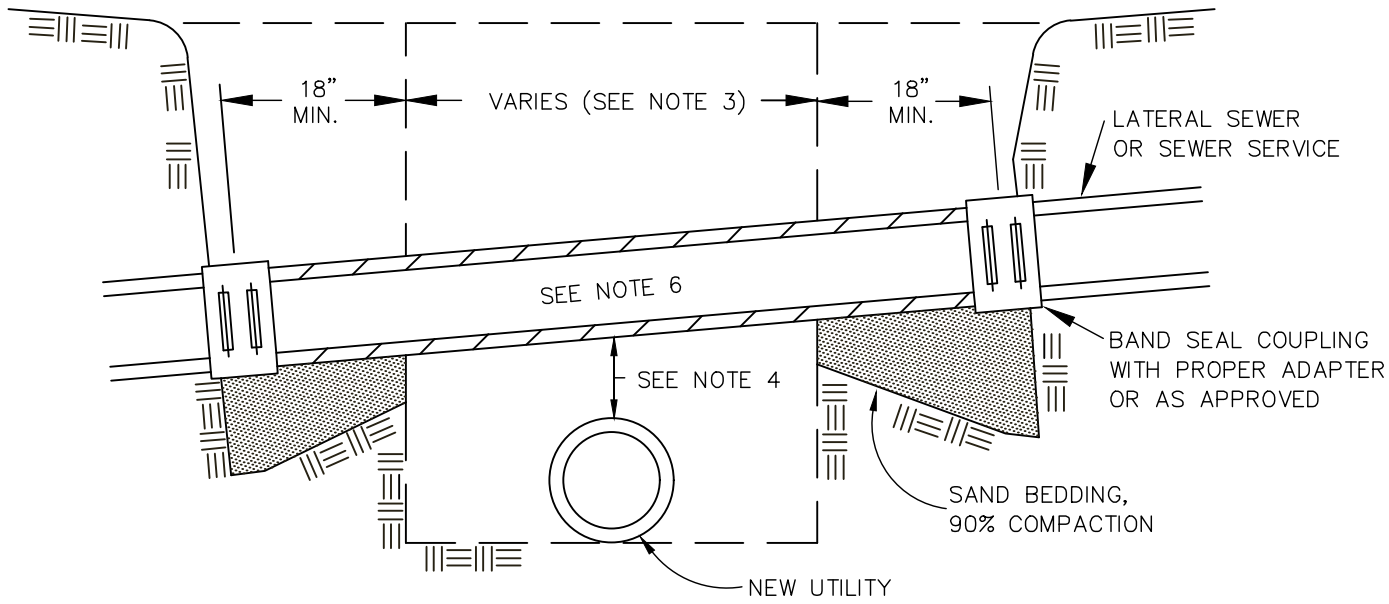

NOTES:

1. INSIDE DIAMETER OF PIPE TO BE THE SAME AS THE PIPE TO WHICH IT CONNECTS.
2. ALTERATIONS OF SEWER GRADES WILL BE PERMITTED ONLY AFTER PERMISSION HAS BEEN RECEIVED FROM THE CITY.
3. WHENEVER THE SPAN OF THE PIPE EXCEEDS 5'-0" REPLACEMENT PROCEDURE AND MATERIAL SHALL BE AS DIRECTED BY THE CITY.
4. MINIMUM CLEARANCE BETWEEN PIPES SHALL BE 3".
5. TRIM THE END OF THE SIDE SEWER PIPE TO A CLEAN CUT UNDEAMAGED END WITH MECHANICAL PIPE CUTTER.
6. EXTRA STRENGTH VITRIFIED CLAY PIPE OR DUCTILE IRON PIPE FOR SANITARY SEWER LINES; FOR STORM DRAIN LINES, CONCRETE PIPE OF THE SAME TYPE REMOVED.
7. BAND SEAL COUPLING SHALL HAVE STAINLESS STEEL SHEAR RING.



	APPROVED _____	DATE _____	
DATE	REVISIONS	BY	

STANDARD DETAIL 504

UTILITY CROSSING

CITY OF MARYSVILLE

PUBLIC WORKS DEPARTMENT

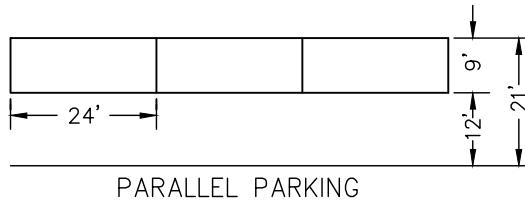

PARALLEL PARKING

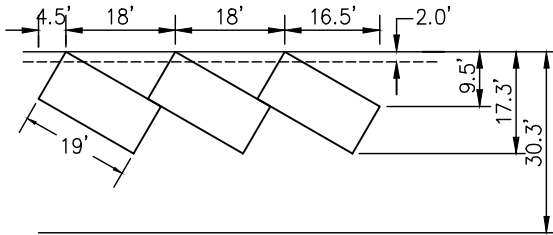

30° PARKING

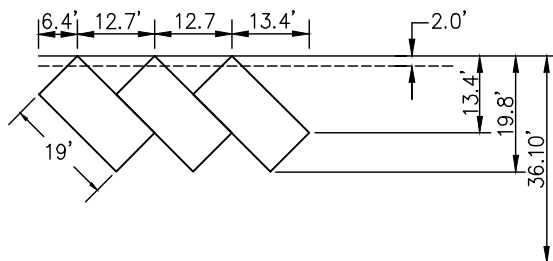

45° PARKING

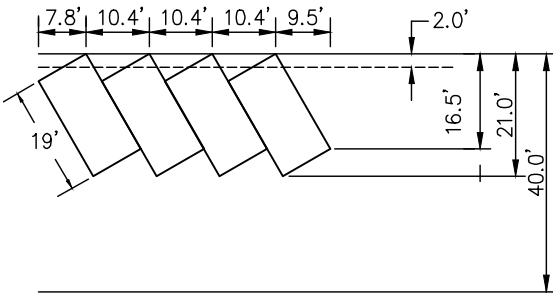

60° PARKING

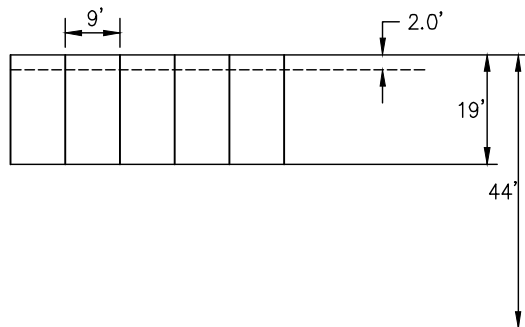

90° PARKING

NOTE: FOR RESIDENTIAL USES 90° STALLS SHOULD BE 10' WIDE

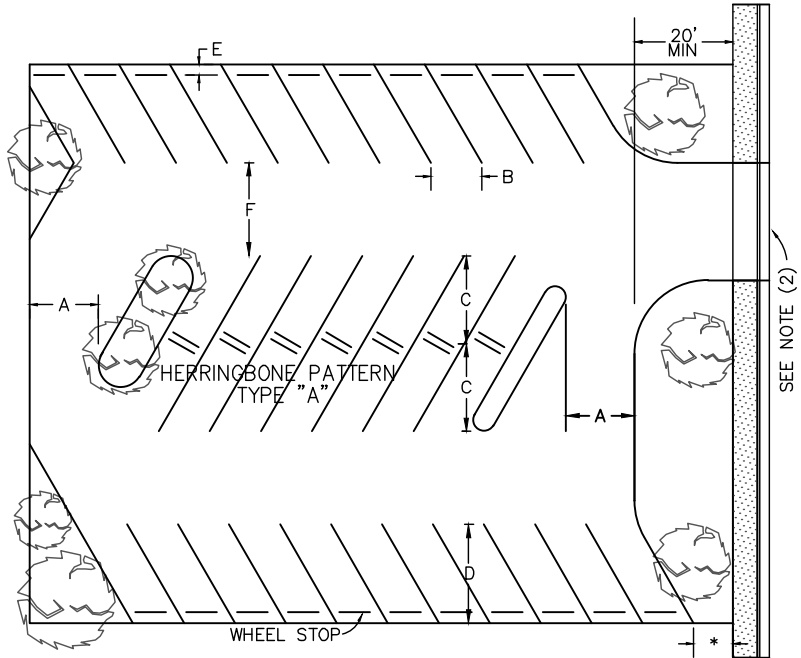

SEE NOTE (2)

DIMENSION TABLE

	PARALLEL	30°	45°	60°	90°	
TURNAROUND	A		17'	14'	14'	
CAR SPACE	B	24.0'	18'	12.7'	10.4'	9'
STALL DEPTH	C	9.0'	14.3'	17.8'	19.0'	17'
STALL DEPTH	D	9.0'	17.3'	19.8'	21.0'	19'
OVERHANG	E		2.0'	2.0'	2.0'	2.0'
ACCESS WAY	F	12'	13'	16.3'	19'	25'

* FRONT YARD & STREET SIDE YARD SETBACKS - SEE ZONING CODE

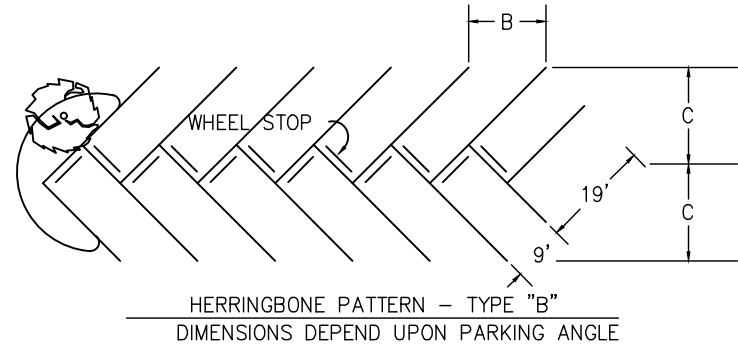

HERRINGBONE PATTERN - TYPE "B"
DIMENSIONS DEPEND UPON PARKING ANGLE

DRIVEWAY STANDARDS

- (1) SEE ZONING CODE FOR DRIVEWAY WIDTHS WITHIN DEVELOPMENT
- (2) SEE STANDARD DETAIL 105 FOR DRIVEWAY REQUIREMENT AT STREET



APPROVED _____ DATE _____

DATE	REVISIONS	BY

STANDARD DETAIL 601

**OFF STREET PARKING LAYOUT
CITY OF MARYSVILLE
PUBLIC WORKS DEPARTMENT**

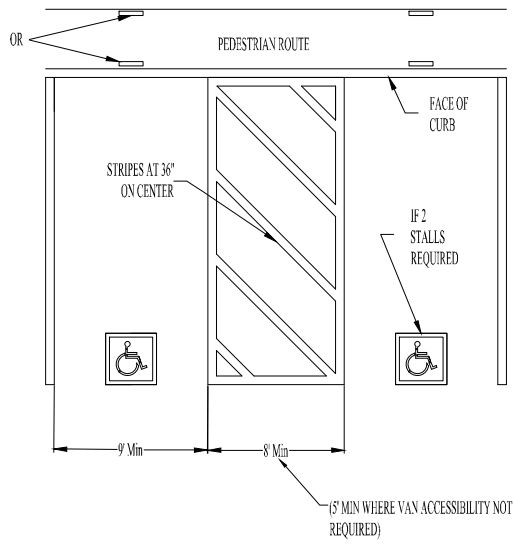

PERPENDICULAR PARKING

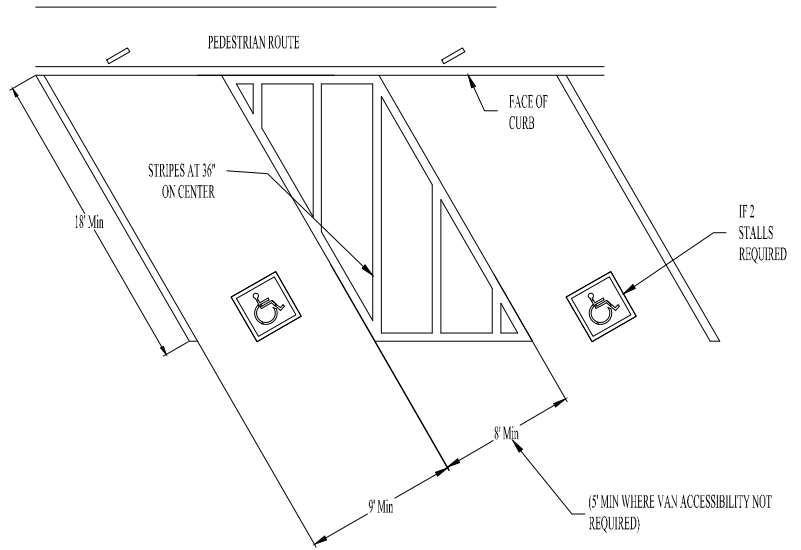

DIAGONAL PARKING

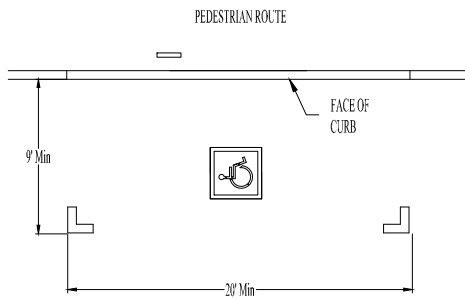

PARALLEL PARKING

NOTES
SIGN
- 70 SQ inches (7x10)
- Ht. 36" or 80"
if in path of travel
- Locate at front of or on building
SYMBOL
- White on Blue Bk.
- Locate at back of stall to be visible with car parked
STRIPING
- White
- Blue curb on street



APPROVED		DATE
DATE	REVISIONS	BY

STANDARD DETAIL 602
HANDICAP PARKING STALL
CITY OF MARYSVILLE
PUBLIC WORKS DEPARTMENT

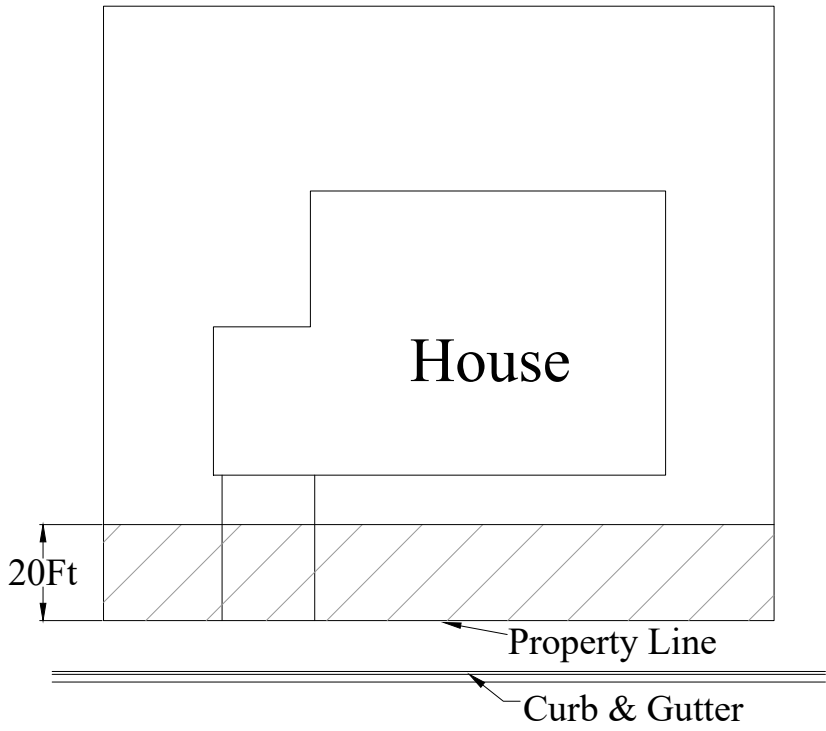

Interior Lots

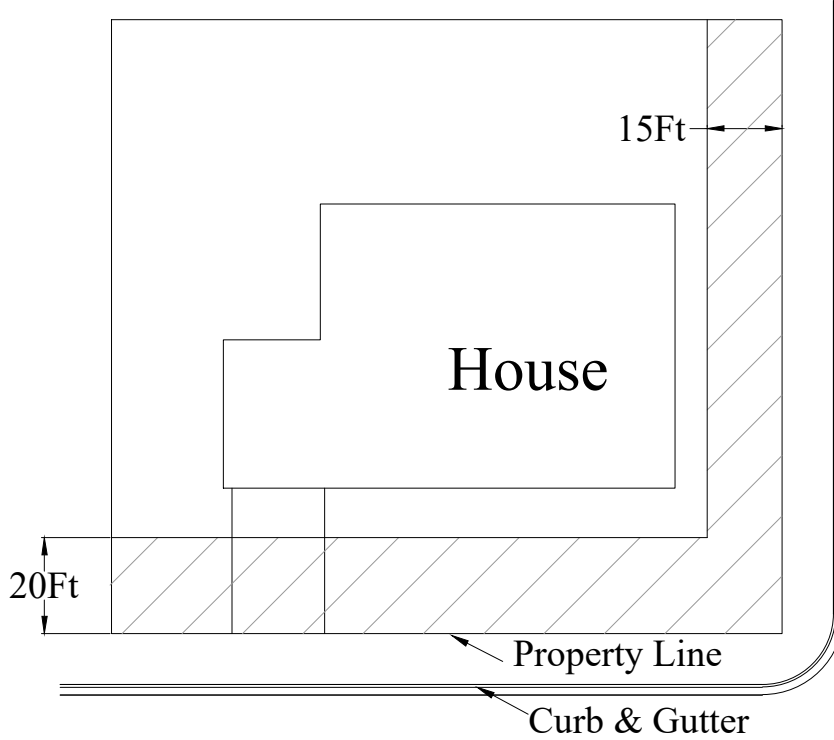

Corner Lots

NOTES

 Area of Limited Fence Height 42 Inch Max

All Other Locations Fence Height 6 Ft Max

Please contact the Building Department with any questions at 749-3904



APPROVED		DATE
DATE	REVISIONS	BY

STANDARD DETAIL 603

GENERAL FENCE REQUIREMENTS

CITY OF MARYSVILLE

PUBLIC WORKS DEPARTMENT

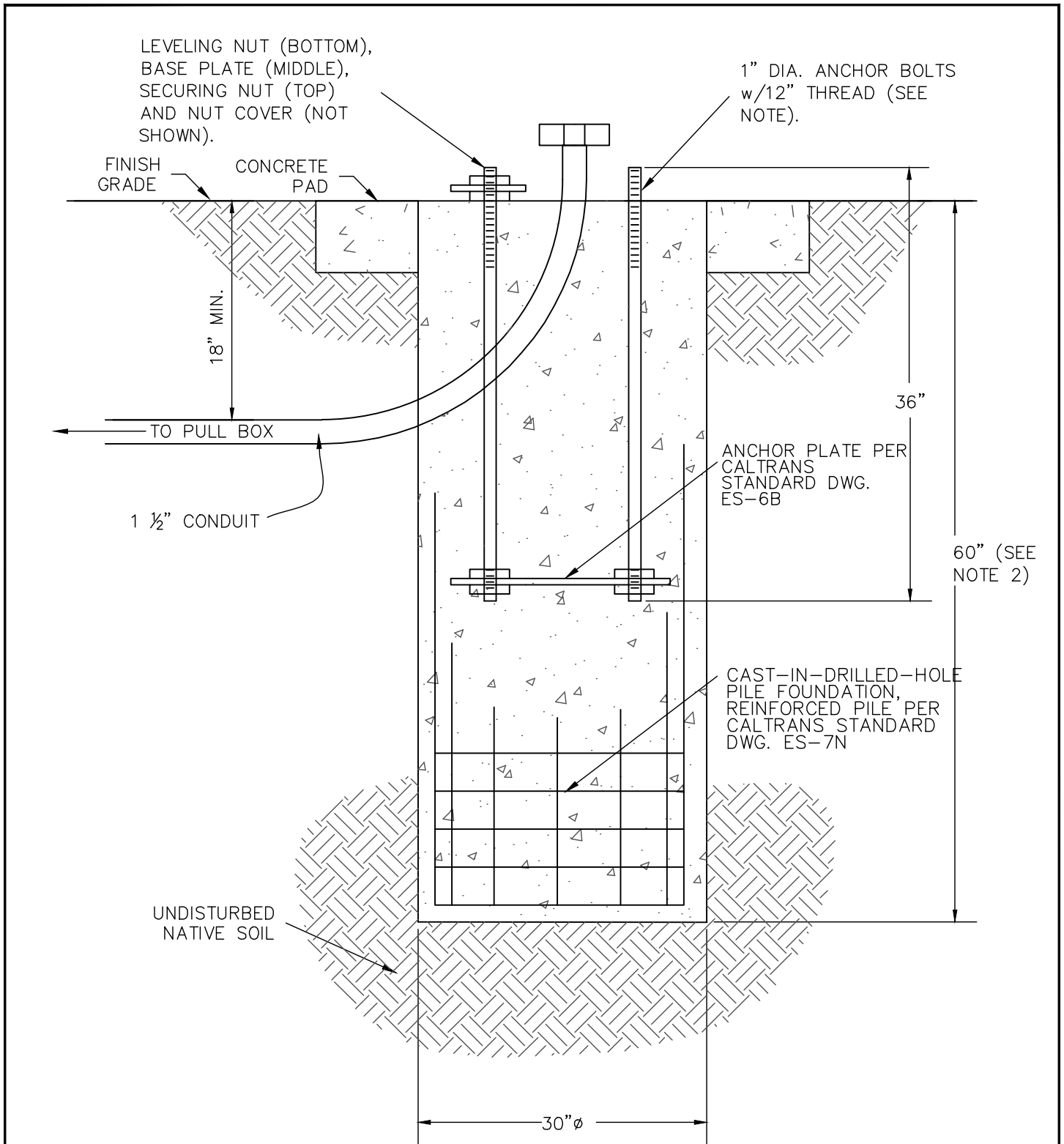

NOTE:

1. SIX SACK CONCRETE SHALL BE USED FOR THE FOUNDATION, AND THE CONCRETE SHALL CURE FOR 7 DAYS PRIOR TO SETTING THE LIGHT POLE.
2. CONFIRM WITH THE CITY ENGINEER FOR DESIGN OF POLE FOUNDATION FOR A TWO MAST ARM APPLICATION.



	APPROVED	DATE	
DATE	REVISIONS	BY	

STANDARD DETAIL 701

LIGHT POLE FOUNDATION

CITY OF MARYSVILLE

PUBLIC WORKS DEPARTMENT

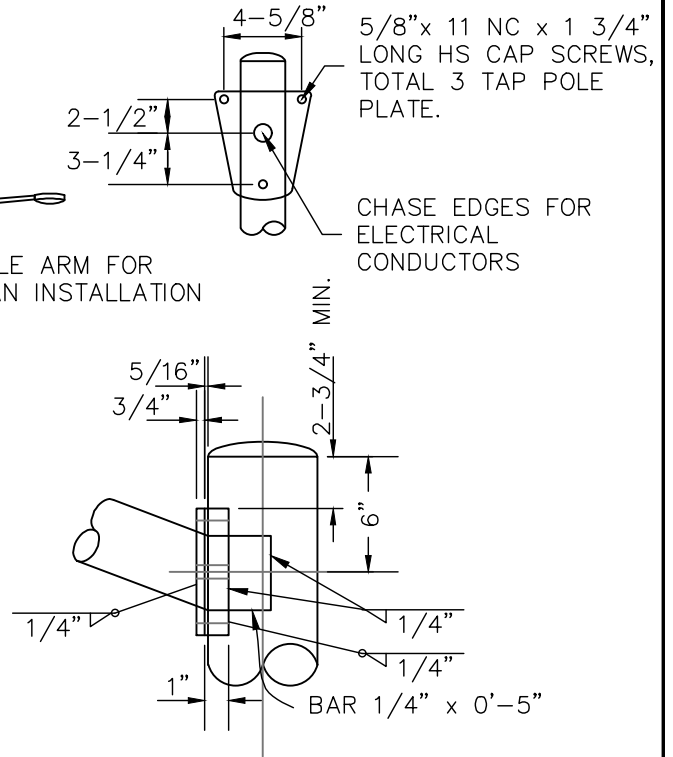
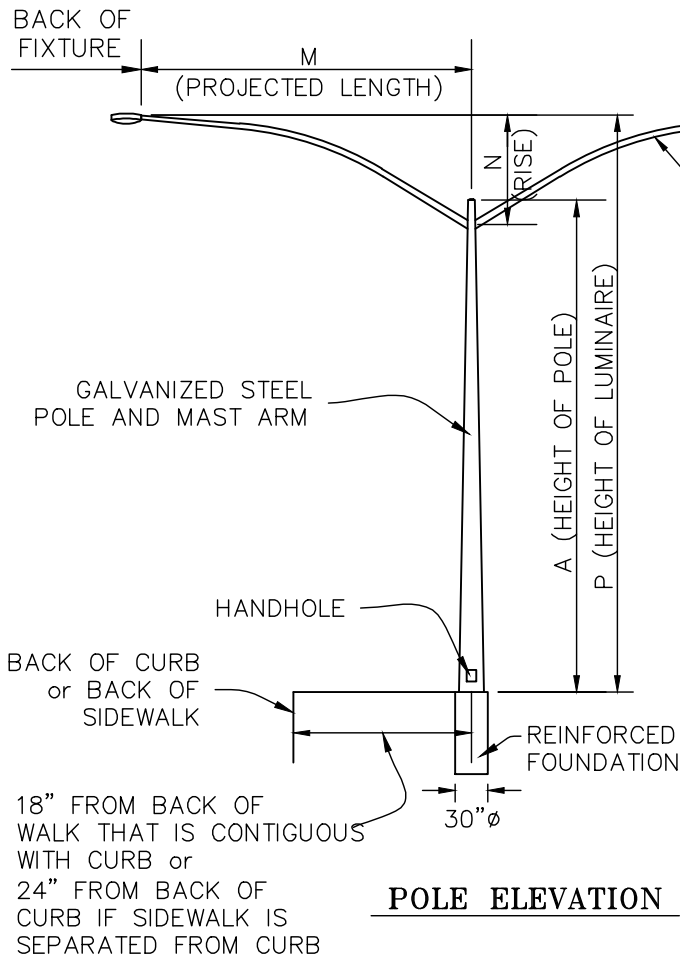

LUMINAIRE ARM CONNECTION

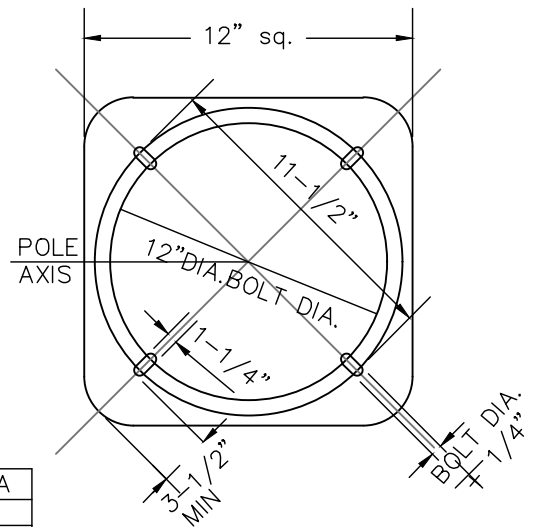

POLE BASE

LUMINAIRE ARM DATA				
M PROJECTED LENGTH	N RISE	MIN. OD AT POLE	THICKNESS	P MOUNTING HEIGHT
6'-0"	2'-0" ±	3-1/4"	0.1196"	31'-6" ±

POLE DATA			
A HEIGHT	MIN OD		THICKNESS
	BASE	TOP	
30'	8"	3-11/16"	0.1196"

BASE PLATE DATA		
THICK- NESS	ANCHOR BOLTS SIZE	BOLT CIRCLE
2"	1"x36"	12"



APPROVED _____ DATE _____

DATE	REVISIONS	BY

STANDARD DETAIL 702

LIGHT POLE & MAST ARM
CITY OF MARYSVILLE
PUBLIC WORKS DEPARTMENT

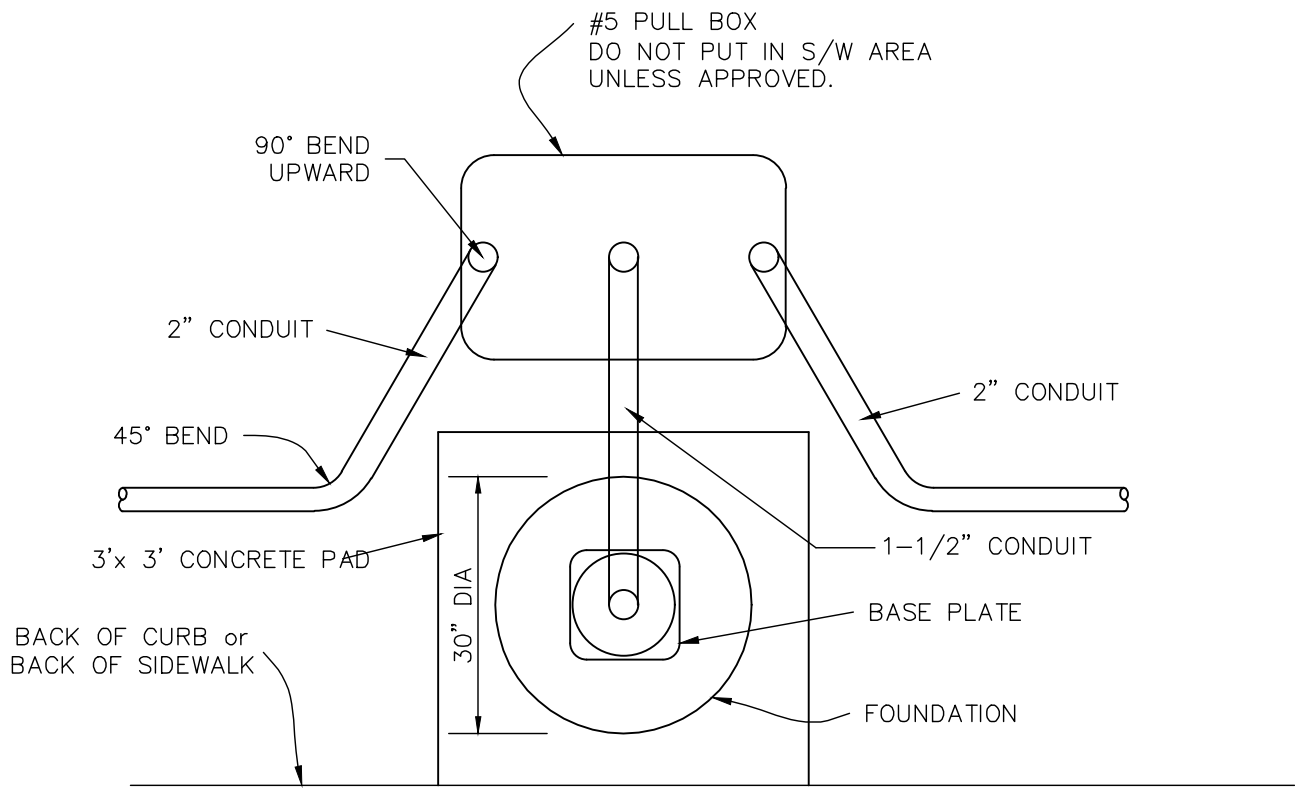

PLAN VIEW

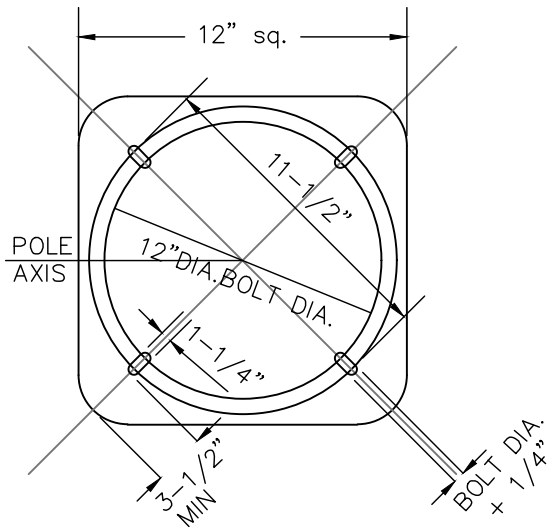

POLE BASE

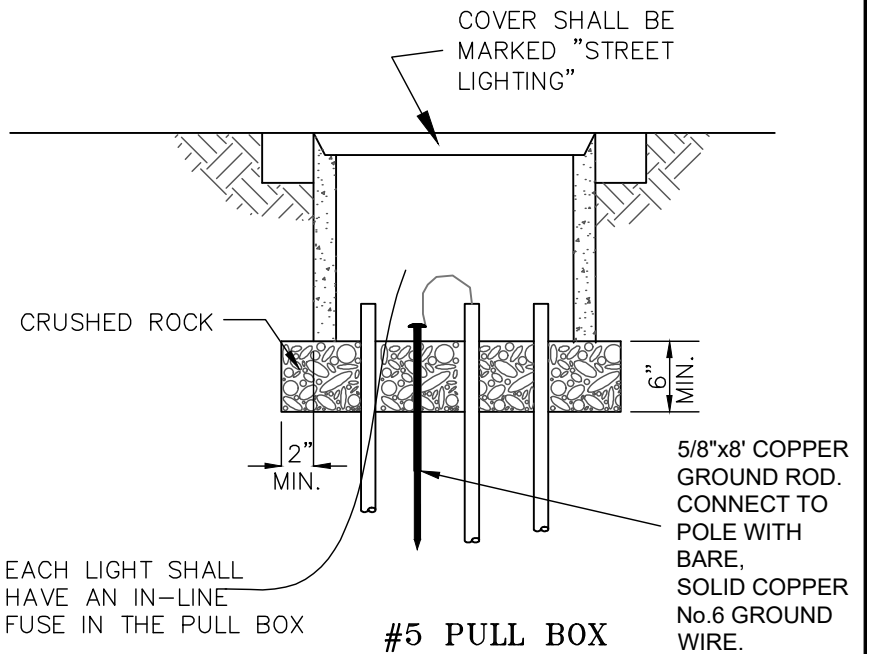

#5 PULL BOX

EACH LIGHT SHALL HAVE AN IN-LINE FUSE IN THE PULL BOX

5/8"x8' COPPER GROUND ROD. CONNECT TO POLE WITH BARE, SOLID COPPER No.6 GROUND WIRE.



APPROVED _____ DATE _____

DATE	REVISIONS	BY

STANDARD DETAIL 703

LIGHT BASE & PULL BOX
CITY OF MARYSVILLE
PUBLIC WORKS DEPARTMENT

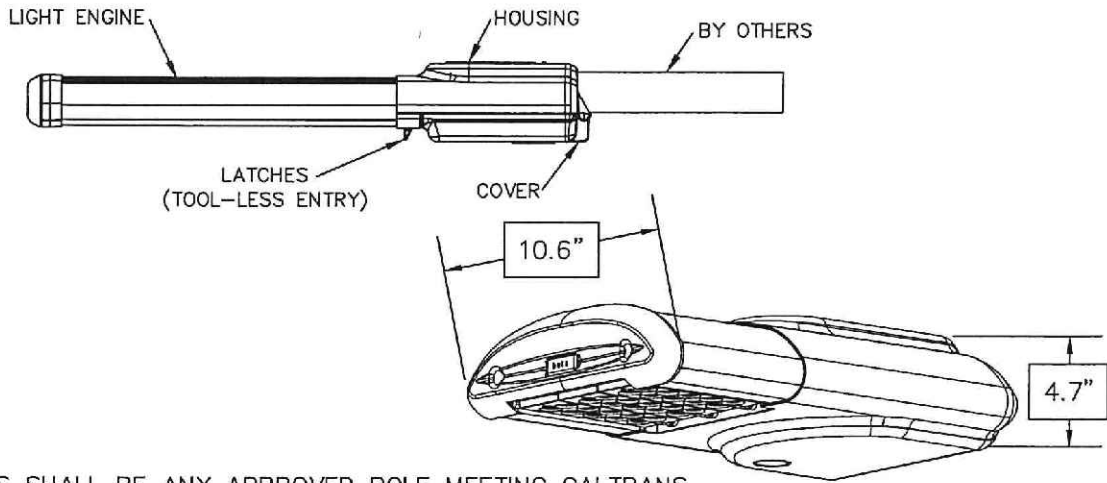

POLES SHALL BE ANY APPROVED POLE MEETING CALTRANS SPECIFICATION TYPE 15.

STREET LIGHTS SHALL BE FROM BETA/CREE LIGHTING. MODEL/CATALOG NUMBERS
 RESIDENTIAL : STR-LWY-2M-HT-02-E-UL-SV-525-DIM-R-40K OR APPROVED EQUAL.
 COLLECTOR : STR-LWY-2M-HT-03-E-UL-SV-525-DIM-R-40K OR APPROVED EQUAL.
 ARTERIAL* : STR-LWY-2M-HT-04-E-UL-SV-525-DIM-R-40K OR APPROVED EQUAL.
 TRAFFIC SIGNAL : STR-LWY-2M-HT-07-E-UL-SV-525-DIM-R-40K OR APPROVED EQUAL.
 SPECIAL CASE : STR-LWY-2M-HT-12-E-UL-SV-525-DIM-R-40K OR APPROVED EQUAL.

*ARTERIAL MODEL MAY BE USED FOR HIGH VOLUME COLLECTOR AS SPECIFIED BY CITY.

THE LUMINAIRE SHALL BE TYPE II MEDIUM LEDway STREETLIGHT OR APPROVED EQUAL.

THE FIXTURE HOUSING SHALL BE SILVER IN COLOR.

ALL LUMINAIRES SHALL BE ROADWAY TYPE (COBRA HEAD) WITH THE LUMINAIRES INSTALLED WITH OPERATIONAL PHOTOCELLS FACING NORTH.

THE OPERABLE CURRENT VARIES FROM LOCATION TO LOCATION. CONFIRM WITH CITY ENGINEER PRIOR TO SPECIFYING OR ORDERING FIXTURE.

THE REFRACTOR SHALL HAVE TYPE II MEDIUM LIGHT DISTRIBUTION PATTERN EXCEPT WHERE DIRECTED BY THE CITY ENGINEER.

LUMINAIRES SHALL OPERATE AT 120 VOLTS AND SHALL BE CUTOFF TYPE UNLESS OTHERWISE APPROVED BY THE CITY ENGINEER.

THE LUMINAIRES SHALL HAVE THE FOLLOWING FACTORY INSTALLED OPTIONS: 0-10V DIMMING, NEMA PHOTOCCELL RECEPTACLE, AND 4000K COLOR TEMPERATURE.

LUMINAIRE					
TYPE	STREET TYPE	COLOR TEMP. (K)	MIN. INITIAL LUMENS DELIVERED	LED COUNT	SYSTEM WATTS
LED	RESIDENTIAL	4,000 (+/- 300K)	3,050	20	35
	COLLECTOR		4,550	30	53
	COLLECTOR*/ARTERIAL		6,075	40	66
	TRAFFIC SIGNAL		10,500	70	120
	SPECIAL CASE		17,850	120	197



APPROVED		DATE	
DATE	REVISIONS		BY

STANDARD DETAIL 704
STREET LIGHT LUMINAIRE
 CITY OF MARYSVILLE
 PUBLIC WORKS DEPARTMENT

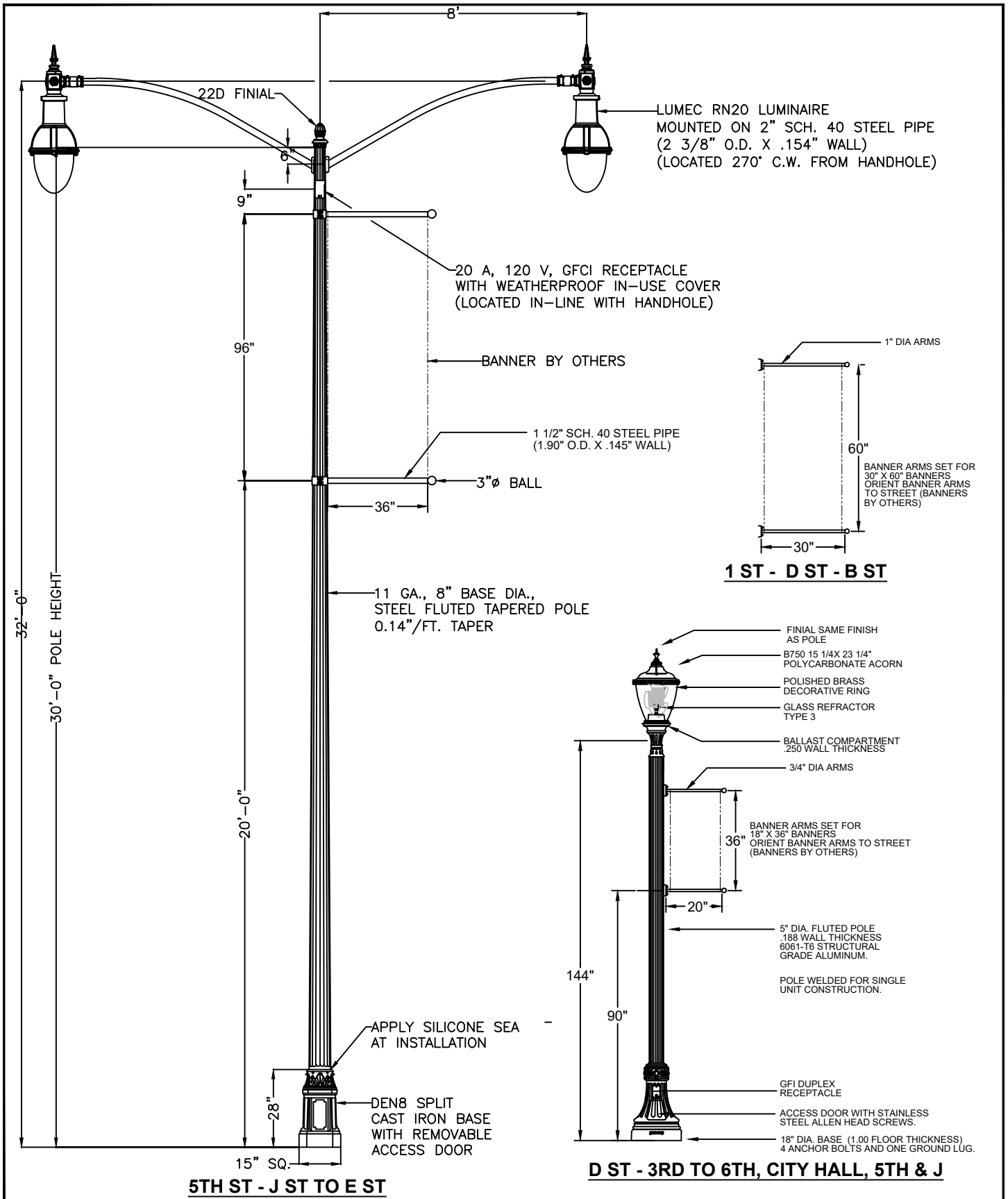

APPROVED		DATE
DATE	REVISIONS	BY

STANDARD DETAIL 705
STREET LIGHT BANNERS
 CITY OF MARYSVILLE
 PUBLIC WORKS DEPARTMENT

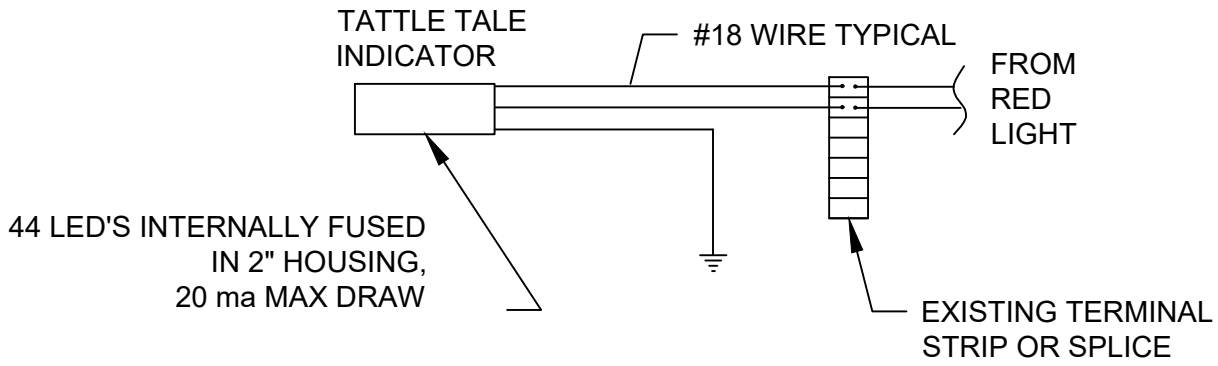

WIRING DIAGRAM

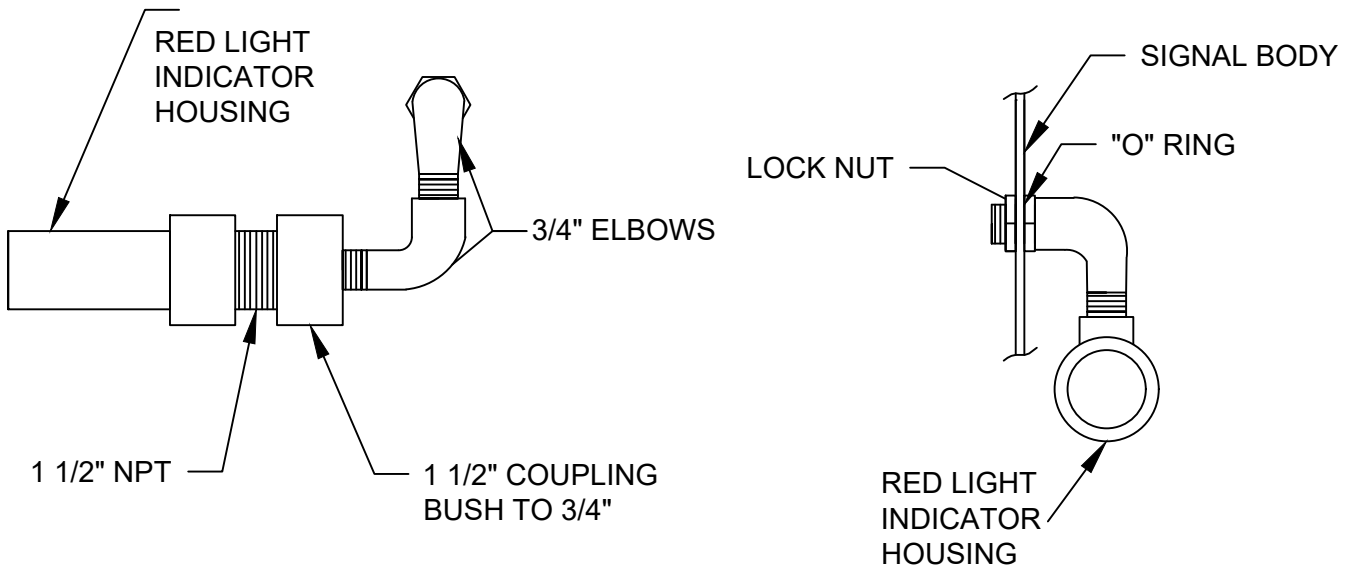

INSTALLATION DETAIL



APPROVED _____ DATE _____

DATE	REVISIONS	BY

STANDARD DETAIL 706

TATTLE TALE RED-LIGHT INDICATORS
CITY OF MARYSVILLE
PUBLIC WORKS DEPARTMENT